

KIMLEY-HORN DESIGN CHARRETTE

TEAM 4

MARGARET APPERSON + CLARRISA COSTEN + YUNA LEE + SARAH SCHAFFER



UNIVERSITY OF
GEORGIA
College of
Environment + Design

Kimley»»Horn
Expect More. Experience Better.

FORMS+SURFACES[®]

BELGARD[®]

PAVES
THE WAY[™]



| | |
|-----------|---|
| 3 | PROJECT VISION |
| 4 | SITE ANALYSIS |
| 5 | PRELIMINARY DESIGN CONCEPTS |
| 6 | FINAL DESIGN CONCEPT |
| 7 | MASTER PLAN OYSTER RIVER CIRCLE FRONT ENTRANCE AMPHITHEATER CONSTRUCTED WETLAND PLAY + RECREATION WATER ACCESS |
| 14 | MATERIAL IMAGERY TREE PLANTING PALETTE SHRUB + GRASS PLANTING PALETTE MATERIAL PALETTE |

GOALS AND OBJECTIVES

- **ACCESSIBLE**
- **WILDLIFE PROTECTION + PRESERVATION**
- **COMMUNITY ENGAGEMENT**
- **MEMORABLE**

VISION STATEMENT / PROJECT NARRATIVE

Oyster River Park, located off the Gulf Coast of Florida, lies in a wave of mangroves. What was once an organic waste landfill is reimagined as a center and symbol for the bustling city of Gulf Coast. The prime real estate off the northeast coast, the luscious mangroves, natural water access points all around and the relatively flat landscape makes it the perfect canvas to repaint and rebuild a park that reflects both the surrounding community and its one-of-a-kind ecosystem. The high point exists at the center of the site with a natural downslope towards the mangroves, allowing for a radial concept with a strong core to connect all the working spaces, paths, and connections. Community/ recreational areas are spread around, including a bandshell amphitheater with a scenic sunrise background, kayaking with the manatees at water access points, a safe children's area including a cool splash pad and an engaging playground surrounded by organic berms. By allocating communal spaces to the outer ring of the site, the flow of circulation works in one way, evenly distributing the weight all around. However to create an efficient path from one side of the site to the other, Beautiful palm trees loosely define the center walkway, creating an unforgettable view from the moment you enter Oyster River Park. It connects to a beautiful boardwalk that hugs the mangroves, winding up a path towards Manatee Outlook. Accessible to people of all ages and backgrounds, we designed paths with the human and natural scale kept in mind. This organic balance between humans, the built and natural environment was key in envisioning Oyster River Park.

SITE ANALYSIS

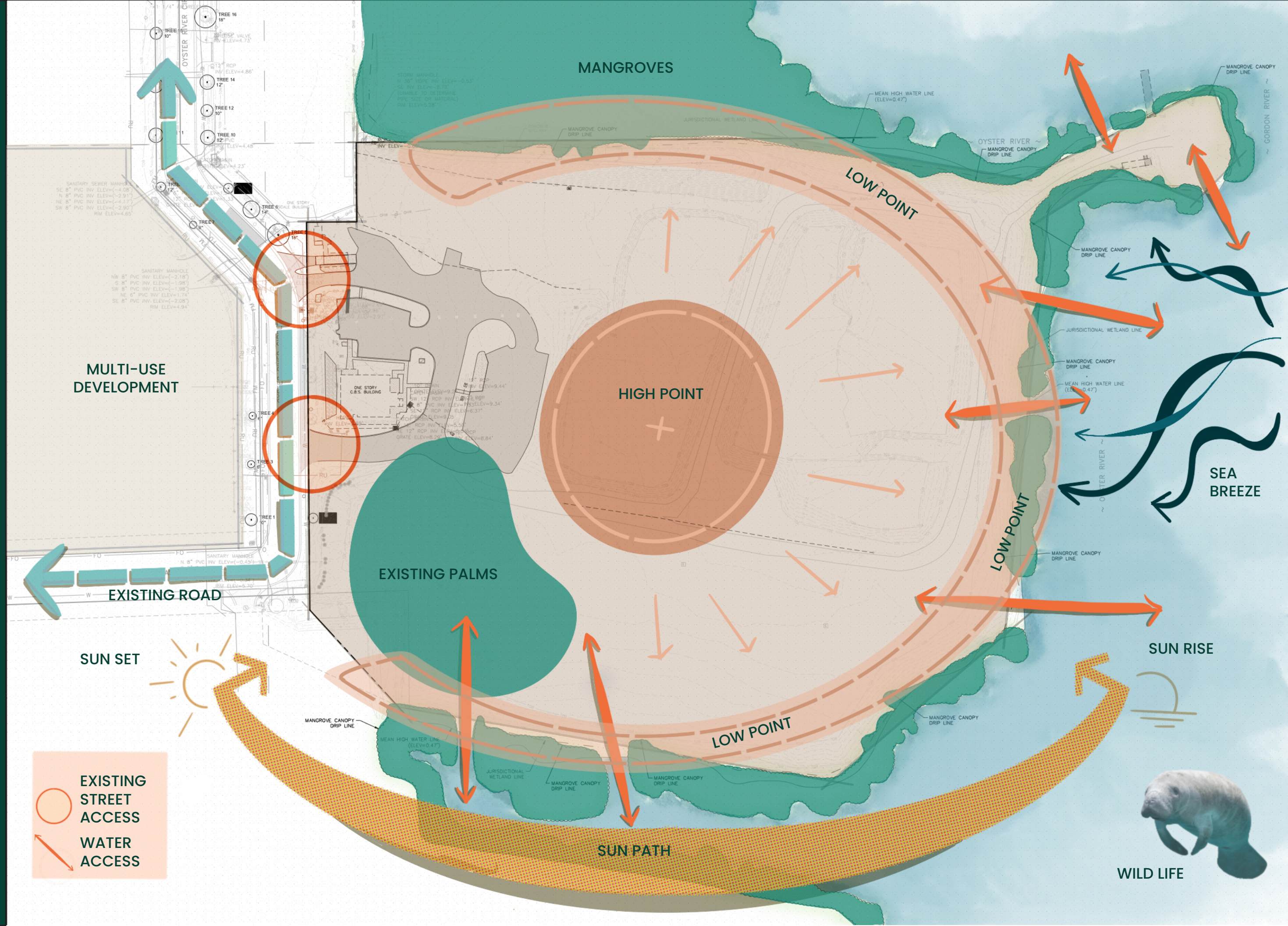

MULTI-USE DEVELOPMENT

EXISTING ROAD

SUN SET

- EXISTING STREET ACCESS
- WATER ACCESS

MANGROVES

HIGH POINT

EXISTING PALMS

LOW POINT

LOW POINT

LOW POINT

SUN PATH

SEA BREEZE

SUN RISE

WILD LIFE

CONCEPT 1

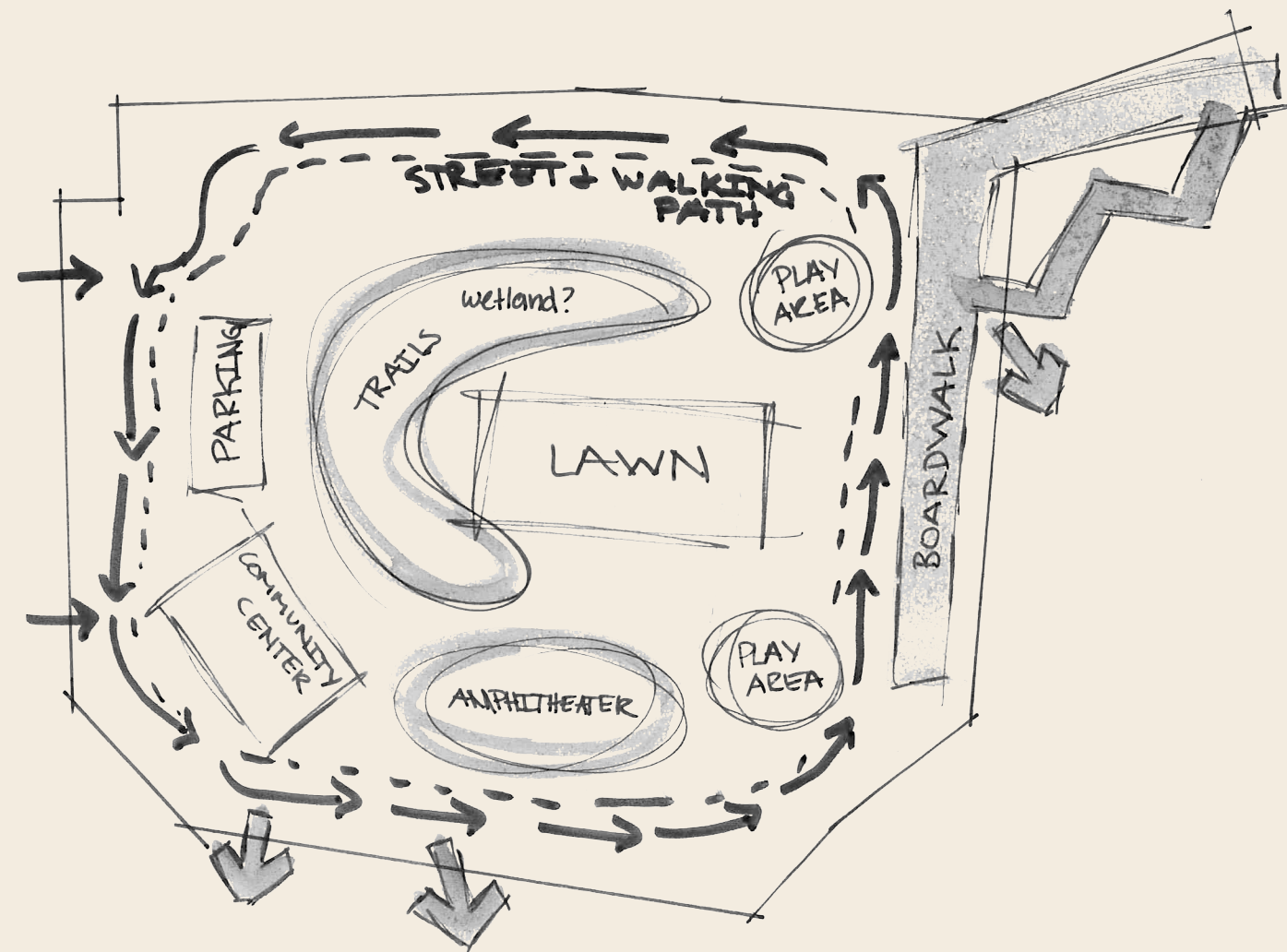

- Everything is localized at the center of the site with community spaces at the core.
- The boardwalk connects the corner real estate as a loop (good opportunity for views).
- Wetland idea introduced.

CONCEPT 2

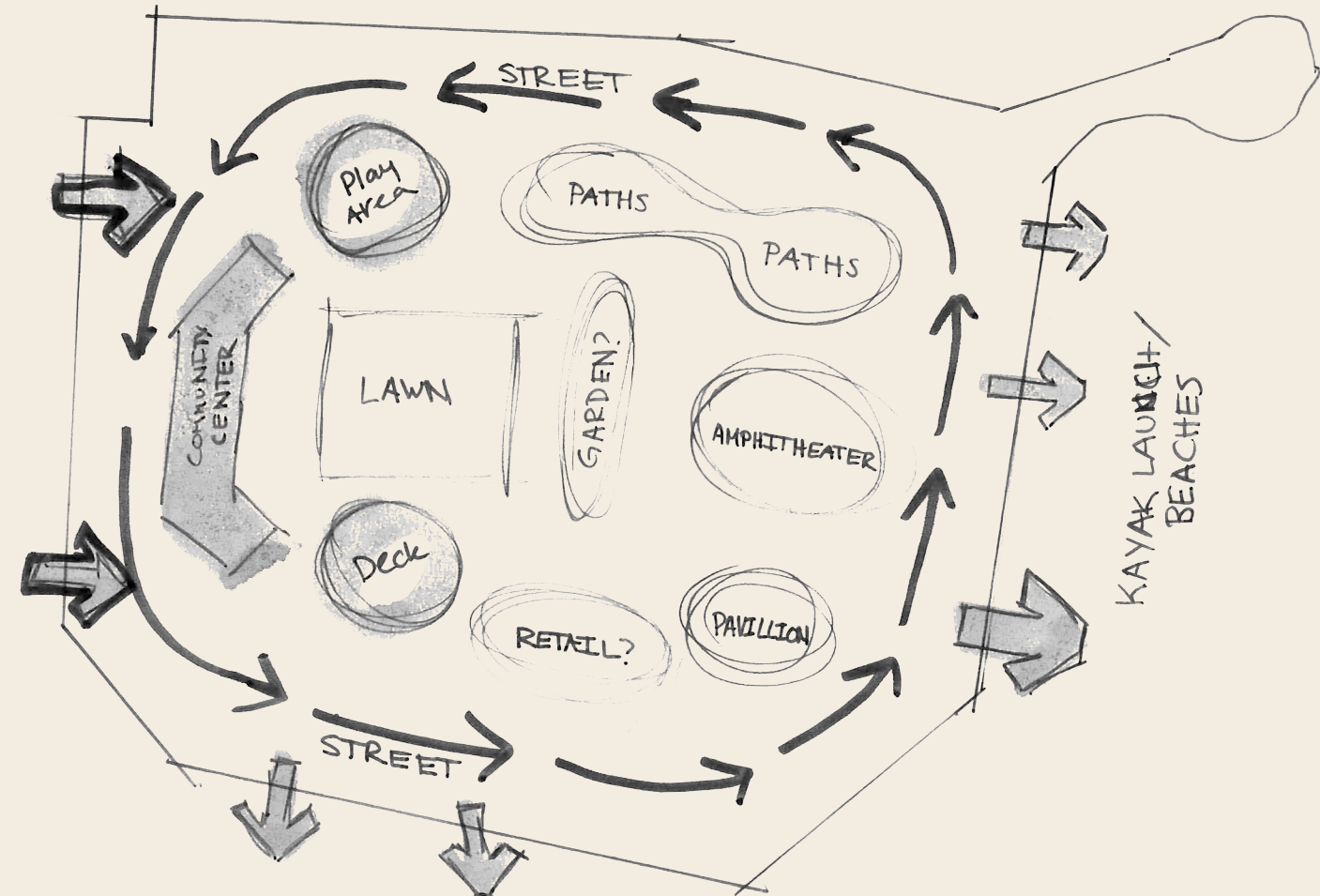

- Community programs items located along center axis with recreational activities / spaces around the site.
- Parking moved off to the side for curb appeal and circulation flow.
- Open arm Community Center form introduced.

FINAL DESIGN CONCEPT

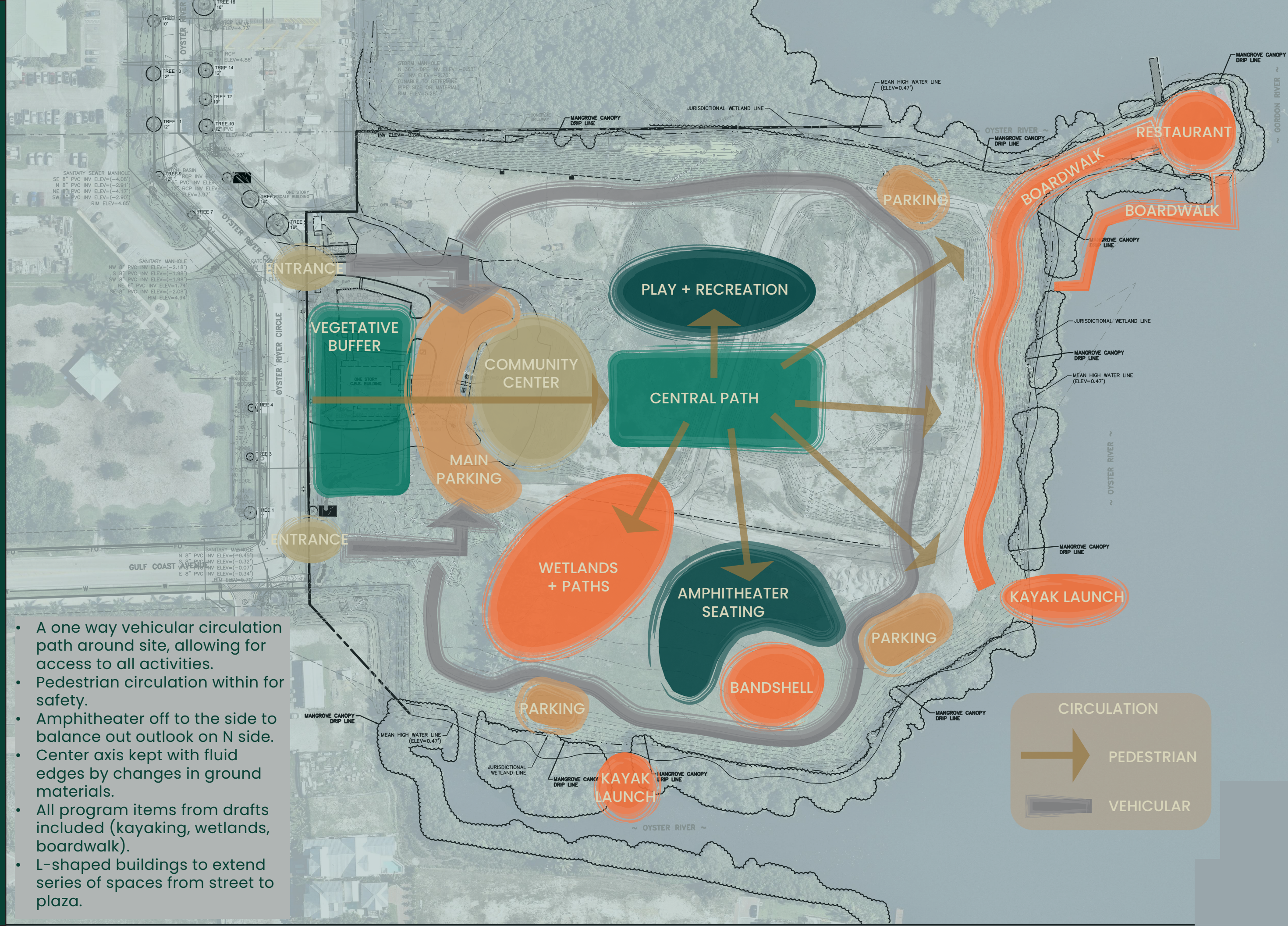

- A one way vehicular circulation path around site, allowing for access to all activities.
- Pedestrian circulation within for safety.
- Amphitheater off to the side to balance out outlook on N side.
- Center axis kept with fluid edges by changes in ground materials.
- All program items from drafts included (kayaking, wetlands, boardwalk).
- L-shaped buildings to extend series of spaces from street to plaza.

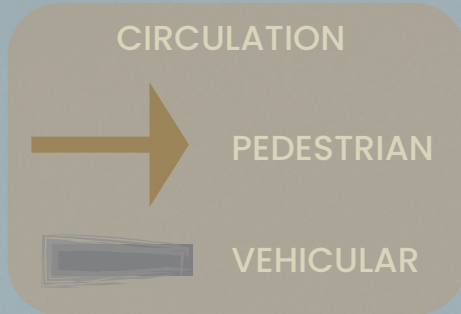

MASTER PLAN



OYSTER RIVER CIRCLE

We took a 40' wide two lane road with no sidewalks, and created a complete street. Oyster River Circle now has two lanes, a bike lane on either side, sidewalks and parallel parking. The street is lined with trees to provide shade for the parked cars as well as to welcome visitors into the site. The large distance between the entrances limited pedestrian access from the multi-use development across the street, so we added a raised crosswalk to double as a pedestrian entrance and a speed bump for passing cars.

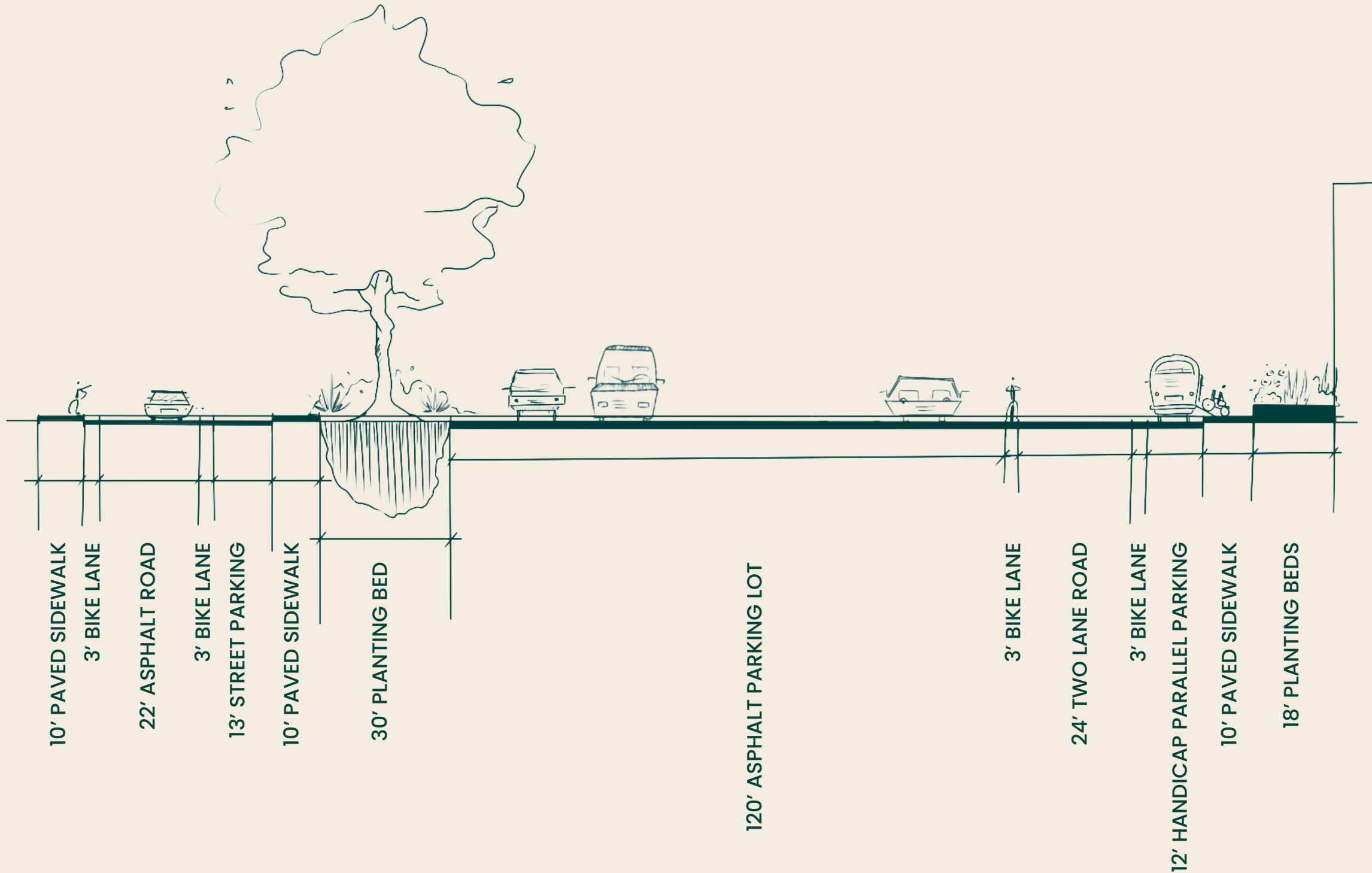

PRECEDENT IMAGERY

FRONT ENTRANCE

At first glance, the eyes meet twin buildings on either side of the main path. The view naturally opens up as the visitor enters through the entrance and into a semi-enclosed plaza. The L-shaped buildings provide a wall of shade from the hot Florida sun on the S side of the site and also separates the flow of traffic from friends and families. Bold palm trees can be seen from every point at the site but the beautiful vista they point towards can only be seen from the front entrance. This special moment signifies only the beginning of the unforgettable Oyster River Park experience.

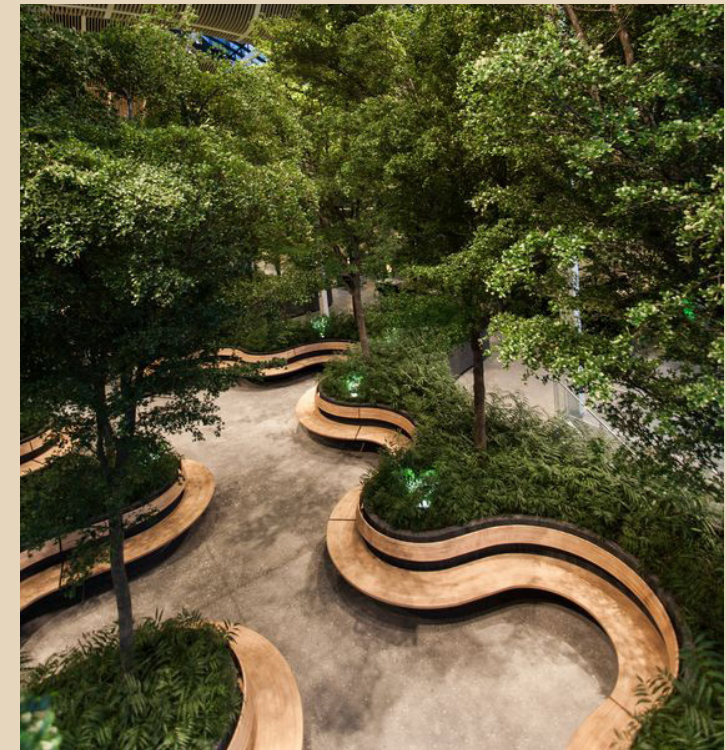

PRECEDENT IMAGERY

AMPHITHEATER

This amphitheater features a 6' wide concrete strip that winds down the terraced lawn to provide wheelchair access. The amphitheater's bandshell is located to enhance the sunrise views for any event that the space may host. The amphitheater can hold about 6,500 guests on the terraces, as well as a large amount of overflow visitors on the expansive lawn. The snake path that leads to the amphitheater, winds through our reconstructed wetlands to provide a scenic stroll from the main parking lot.

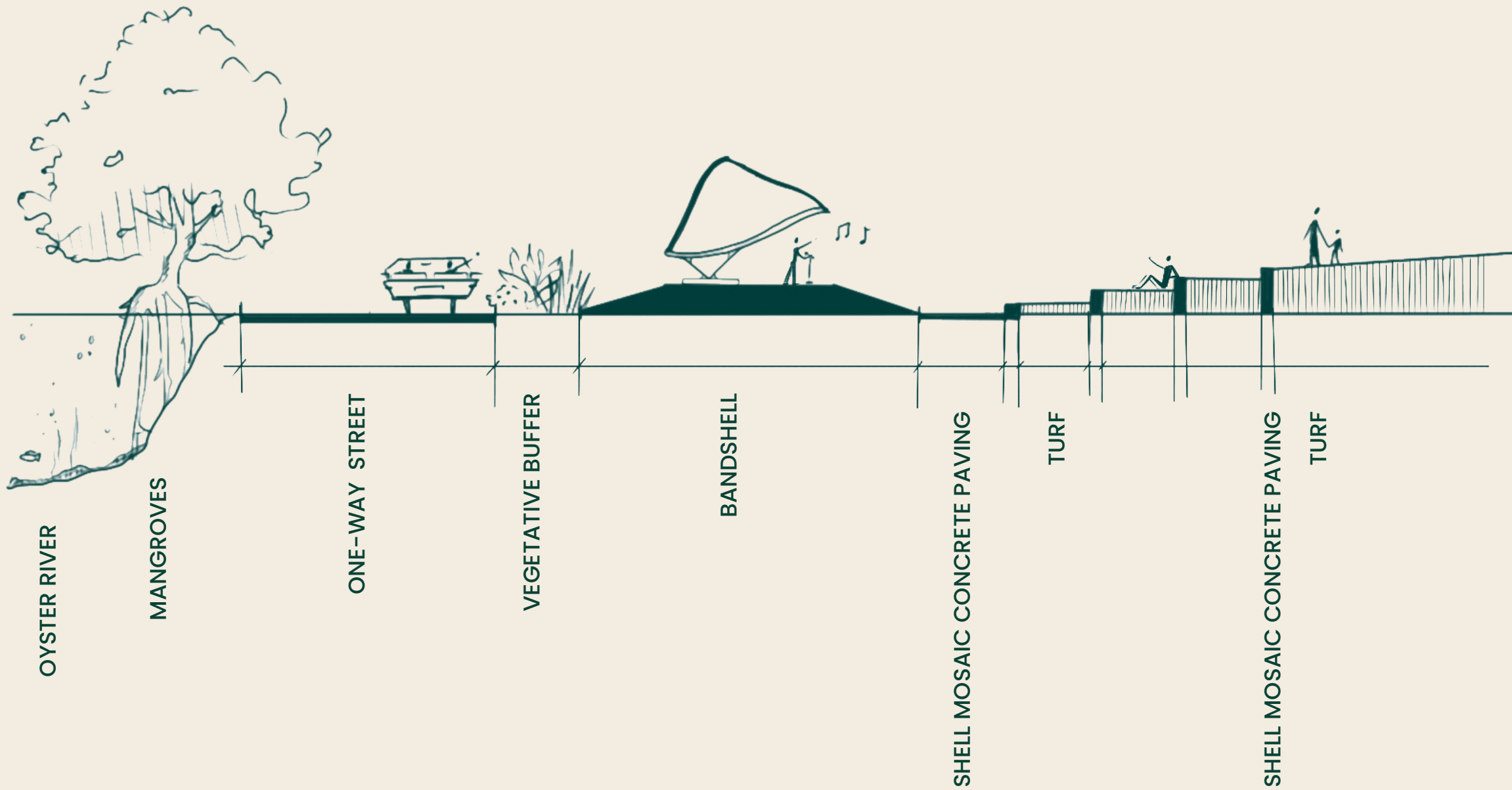

PRECEDENT IMAGERY

CONSTRUCTED WETLAND

The constructed wetlands are meant to increase the wildlife habitat and create an educational experience for guests who visit Oyster River Park. These wetlands are an expansion of one of the water access points between the mangroves. Wetlands provide critical habitat, breeding grounds and sources of food for shellfish, fish, birds, amphibians and other native organisms. The crucial role that wetlands play, enhance many state and tribal fishing economies. These services generate commercial, recreational and aesthetic benefits as well. Wetlands also control erosion, limit flooding, moderate groundwater levels and base flow, assimilate nutrients, protect drinking water sources and buffer coastal areas from storm surges. The winding path that circulates through the constructed wetlands has ecological information about the wildlife that inhabits this area.

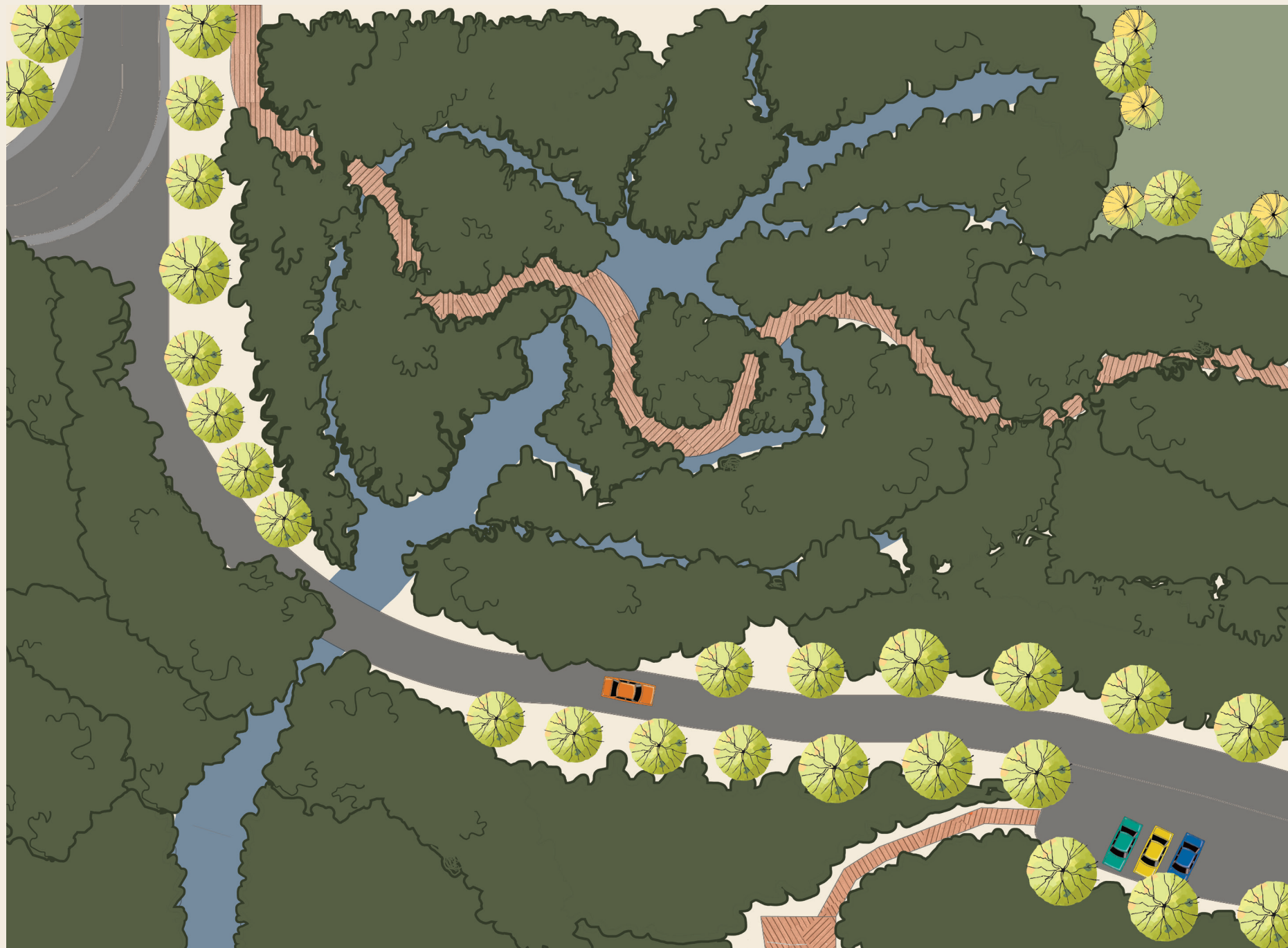

PRECEDENT IMAGERY

PLAY + RECREATION

In our recreational designs we wanted to reuse the existing materials on site to construct berms that enclose the children's play area and the beach volleyball courts. The berms are also meant to be used as a natural playground structure with tunnels and slides for children to interact with. The playground area is attached to a splashpad that has more seating for parents and other family members. The volleyball courts can host small tournaments, with a comfortable place for an audience to watch the game.

BEACH VOLLEYBALL



PLAYGROUND PRECEDENT IMAGERY



SPLASHPAD PRECEDENT IMAGERY



WATER ACCESS

The existing water access points were reimagined as kayak launches, including two ADA accessible launching docks. Connecting the beachfront area, two kayak launches and Manatee Outlook is an over-the-water boardwalk, suitable for high and low tide, that hugs the architectural mangroves along the east side of the side, providing a unique experience for visitors.



PRECEDENT IMAGERY

TREE PLANTING PALETTE



WAX MYRTLE



CITRUS TREES



COCO PALM



JAPANESE FERN TREE



EVERGREEN SWEETBAY MAGNOLIA



EXISTING MANGROVES



CRAB APPLE



BALD CYPRESS



FIG TREE

SHRUB + GRASS PLANTING PALETTE



INLAND SEA OATS



FOUNTAIN GRASS



MEXICAN FEATHER GRASS



LIATRIS



SOUTHERN SHIELD FERN



MUHLY GRASS



NIGHT-BLOOMING JASMINE



BUDDLEIA



LEMON GRASS



DWARF UMBRELLA TREE

MATERIAL PALETTE



BOARDWALK

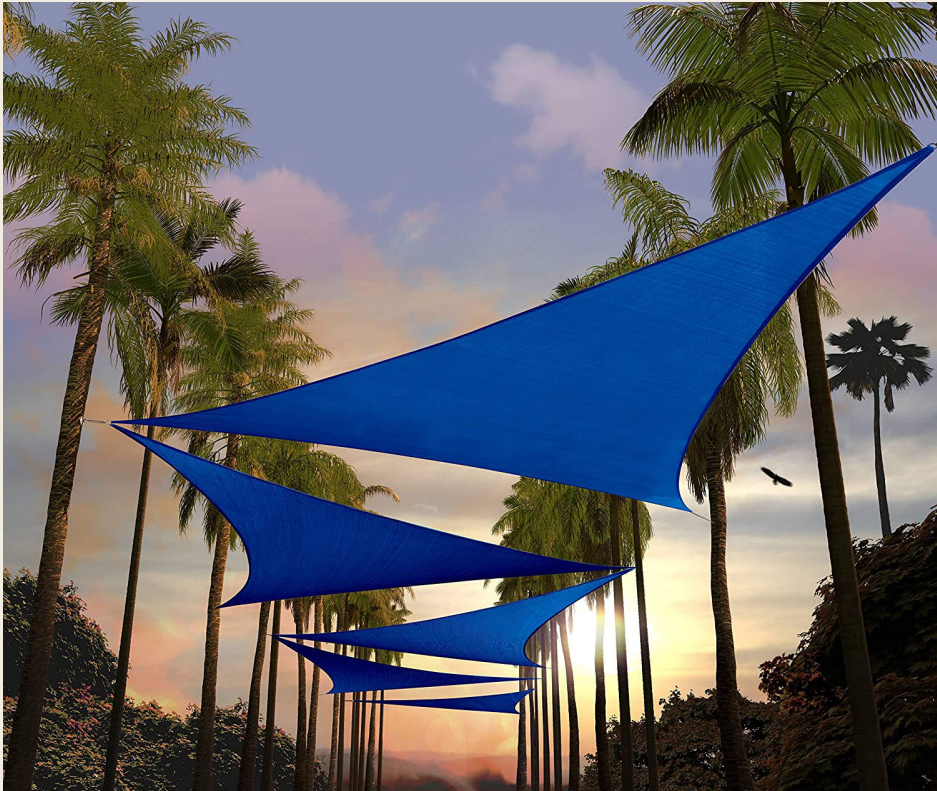

CANVAS SHADE SAILS



RECYCLED CONCRETE BENCH



SHELL MOSAIC CONCRETE PAVING