

OYSTER RIVER PARK

Team 13- Alex Penel, Luke Maddox,
Molly Williams, Nadia Yankovsky, and
Inglis Filbern

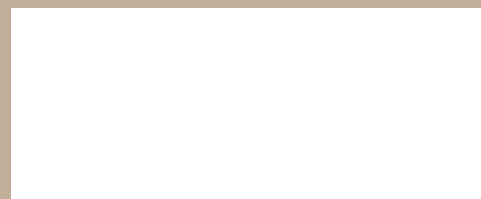

Kimley»Horn
Expect More. Experience Better.

FORMS+SURFACES®

BELGARD® | PAVES THE WAY™



TABLE OF CONTENTS

Cover		Material Imagery.....12
Table of Contents.....i.		Furnishings.....13
Project Narrative.....1		Plant Imagery.....14
Site Plan.....2		Back Cover.....15
Analysis.....3		
Concepts.....4		
Concepts.....5		
Perspectives.....6		
Sketching.....7-8		
Precedent Imagery.....9-11		

i. Team 13- Alex Penel, Luke Maddox, Molly Williams, Nadia Yankovsky, and English Filbern

Looking at Oyster River Park, we knew we saw a lot of potential with the old lighthouse on the outstretched eastern part of the site, as well as the old Spanish-Colonial style infrastructure scattered throughout. Through our analysis we found that there was a lot of valuable mangrove densities along all borders of the property, these would be untouched. As this was a crucial part to the history of this region, this certainly had to be a staple part of our design.

Complete cyclical circulation was one of our main goals to really highlight the strolling abilities for all ages here. Thus, the curvilinear dark mahogany wood boardwalk surrounding the main leisure area. This boardwalk features clean edges with consistent tree cover to emulate and enhance the density of the surrounding mangroves. The trees canopy over to provide a cool and comforting experience as you visit and walk the entire circulation getting a view of every aspect of the park along your way.

To begin the experience, one, if driving, comes in at the west side of the park to leave their cars on the lush turfgrass parking spaces, and is greeted to the boardwalk by the beautiful, refurbished Spanish-Colonial style pavilion to then start on the boardwalk in either direction.

Along the path on the north side of the park, we have a splash pad surrounded by some of the reclaimed terracotta pavers uncovered on the site, along with the old infrastructure preserved and turned into a quaint café, ice-cream shop, and more restroom amenities. On the south side there we have the volleyball court where the boardwalk merges with a curvilinear stacked seating and viewing area. In the center of the green space, which the boardwalk surrounds, we have a small amphitheater for community engagement and the path turns into a softer white gravel path that leads north along the east mangroves edge. Our main historic preservation becomes the monument of the site, the lighthouse. The lighthouse, a common tourist location is the focal point of the path and park, leading you to that outstretched land. Around the base of the lighthouse, we saw an opportunity for community and placed a seating area and place for food.

With the mangroves specifically, it was very important to be able to fully appreciate and be a part of them, so we included a smaller discrete boardwalk on the water on the northeastern portion of the park. This path will be utilized as both a leisurely and educational resource. For further mangrove interaction we also have kayak sights on the southwestern portion of the park, for further recreation and education.





Drawing name: C:\Users\Kate.Winn\OneDrive - KHA\OneDrive\2022 Charrette\Baker Park CAD Files\Send to UGA\Allin Park - Base.dwg Layout1 Jan 14, 2022 1:36pm by: Kate Winn

This document, together with the concepts and designs presented herein, as an instrument of service, is intended only for the specific purpose and client for which it was prepared. Reuse of and improper reliance on this document without written authorization and adaptation by Kimley-Horn and Associates, Inc. shall be without liability to Kimley-Horn and Associates, Inc.

 PREPARED BY Kimley-Horn & Associates, Inc. 901 MARKET STREET, SUITE 200 CHARLOTTE, NC 28202 WWW.KIMLEY-HORN.COM																																												
COLLEGE OF ENVIRONMENT + DESIGN UNIVERSITY OF GEORGIA																																												
CITY OF GULF COAST PARKS & RECREATION 1 GULF OF MEXICO LANE GULF COAST, FL																																												
<table border="1" style="width: 100%; border-collapse: collapse;"> <thead> <tr> <th style="width: 60%;">NO.</th> <th style="width: 30%;">ISSUANCE AND REVISION DESCRIPTIONS</th> <th style="width: 10%;">DATE</th> <th style="width: 10%;">BY</th> </tr> </thead> <tbody> <tr><td> </td><td> </td><td> </td><td> </td></tr> <tr><td> </td><td> </td><td> </td><td> </td></tr> <tr><td> </td><td> </td><td> </td><td> </td></tr> <tr><td> </td><td> </td><td> </td><td> </td></tr> <tr><td> </td><td> </td><td> </td><td> </td></tr> <tr><td> </td><td> </td><td> </td><td> </td></tr> <tr><td> </td><td> </td><td> </td><td> </td></tr> <tr><td> </td><td> </td><td> </td><td> </td></tr> <tr><td> </td><td> </td><td> </td><td> </td></tr> <tr><td> </td><td> </td><td> </td><td> </td></tr> </tbody> </table>	NO.	ISSUANCE AND REVISION DESCRIPTIONS	DATE	BY																																								
NO.	ISSUANCE AND REVISION DESCRIPTIONS	DATE	BY																																									
PROJECT OYSTER RIVER PARK 1 GULF OF MEXICO LANE GULF COAST, FL																																												
DRAWN BY: KHA DESIGNED BY: KHA REVIEWED BY: KHA DATE: 01/14/2022																																												
TITLE EXISTING CONDITIONS SHEET NUMBER L0-00																																												

SURVEY/ANALYSIS

Team 13

Concept #1

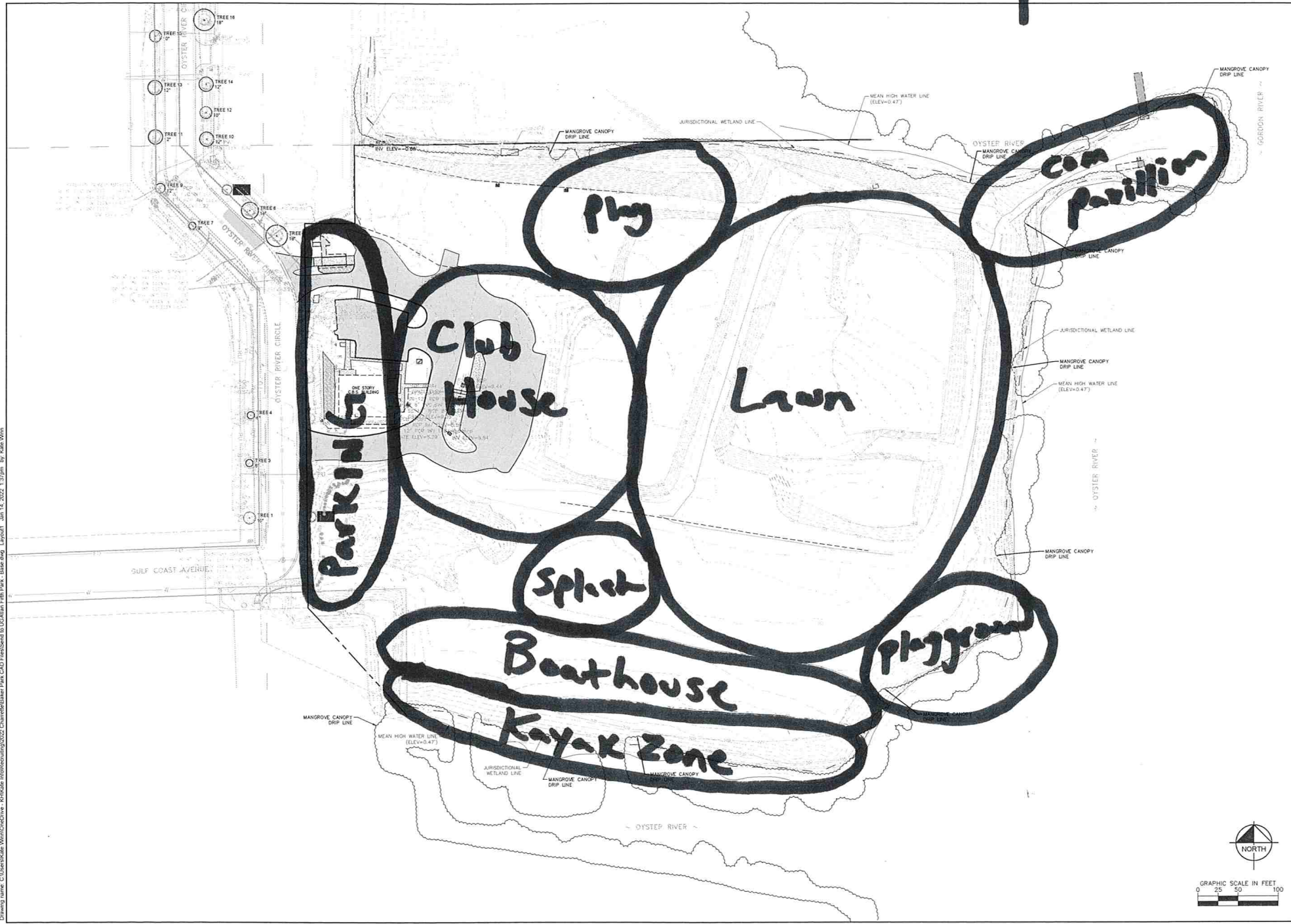

Drawing name: C:\Users\Kade\OneDrive - KIMLEY HORN\Documents\2022\Charmelle\Oyster Park CAD\Final\Site Plan - Base.dwg, Layout1, Jan 14, 2022, 12:29pm, by: Kade Wain

This document, together with the concepts and designs presented herein, is an instrument of service, intended only for the specific purpose and client for which it was prepared. Reuse of and improper reliance on this document without written authorization and a stipulation by Kimley-Horn and Associates, Inc. shall be without liability to Kimley-Horn and Associates, Inc.



CITY OF GULF COAST PARKS & RECREATION
1001 GULF COAST BLVD
GULF COAST, FL

NO.	ISSUANCE AND TECHNICAL DESCRIPTIONS	DATE	BY

PROJECT
OYSTER RIVER PARK
1 OYSTER RIVER CIRCLE
GULF COAST, FL

DRAWN BY: KHA
DESIGNED BY: KHA
REVIEWED BY: KHA
DATE: 01/14/2022

TITLE
EXISTING CONDITIONS
SHEET NUMBER
LO-00

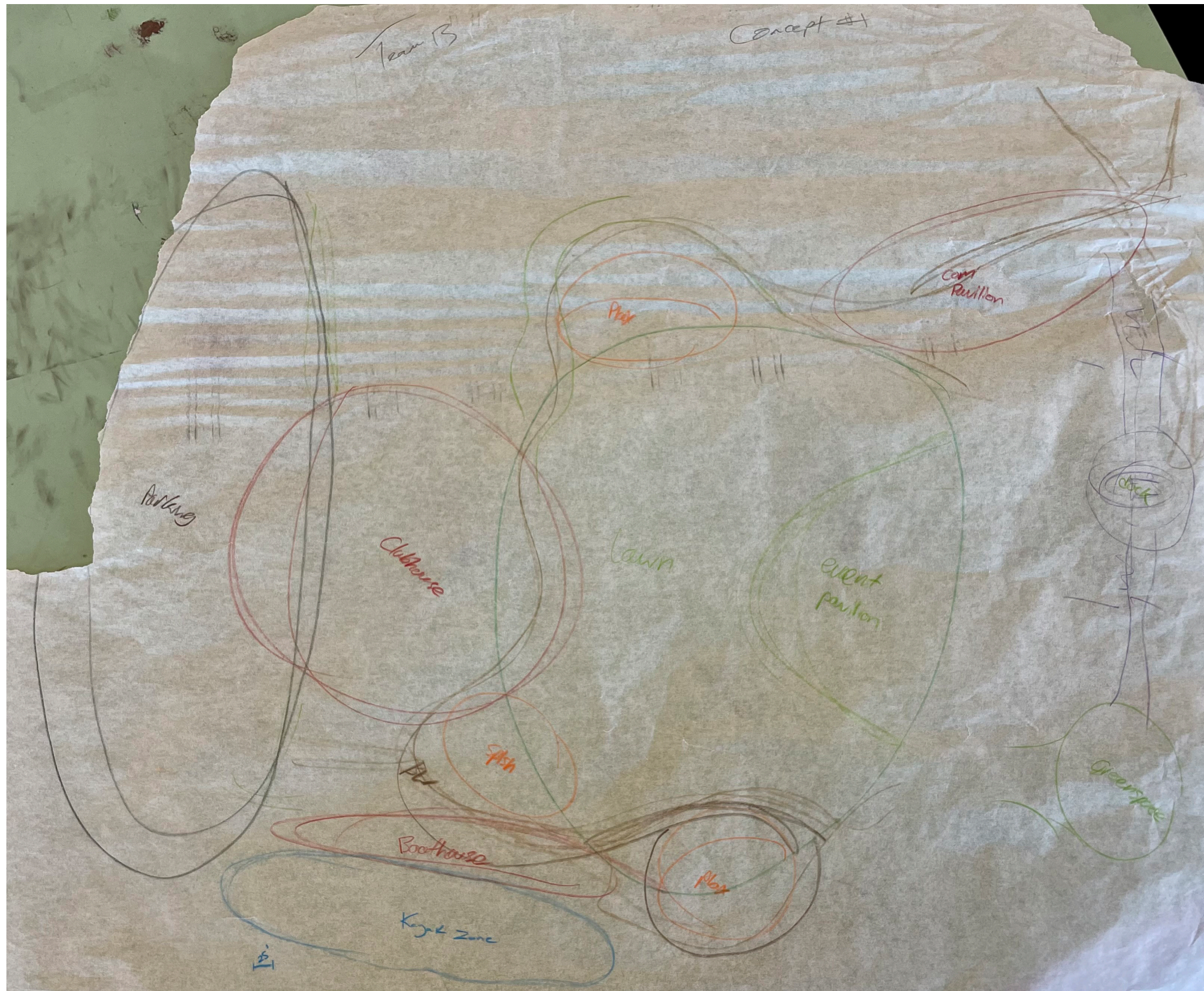

CONCEPTS

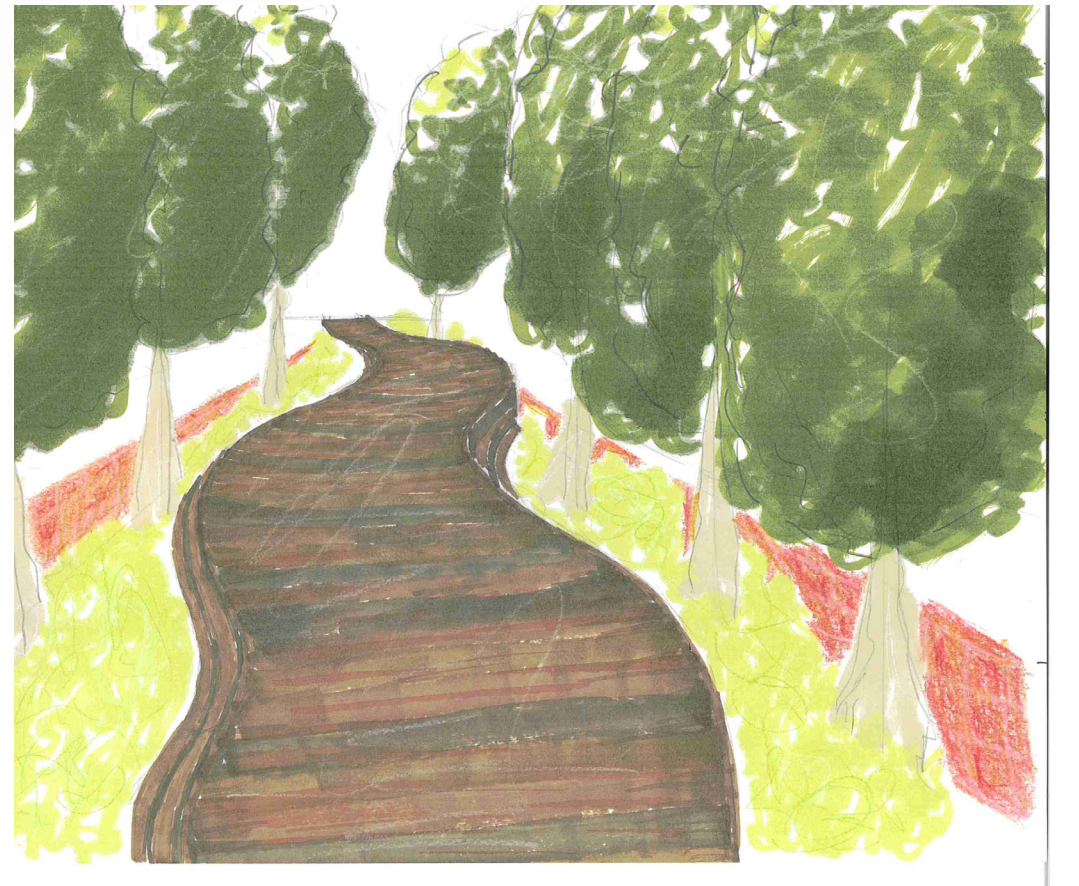
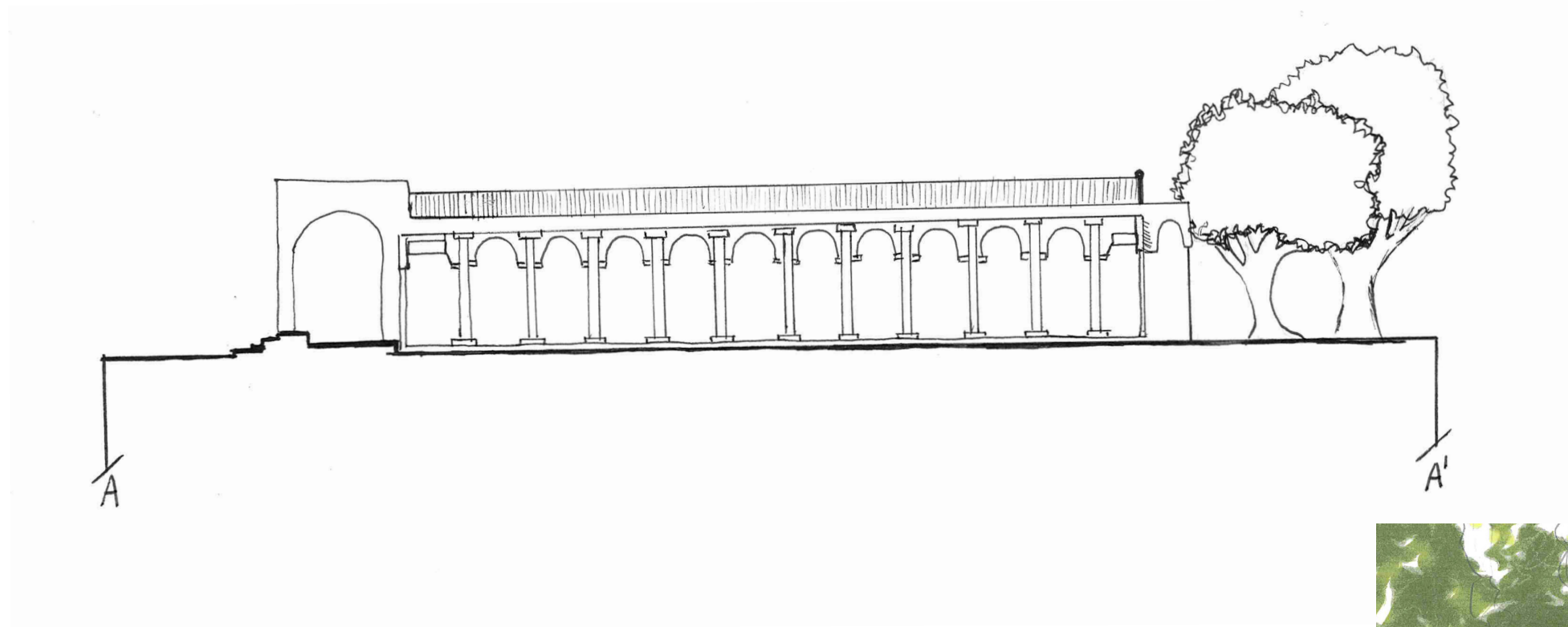



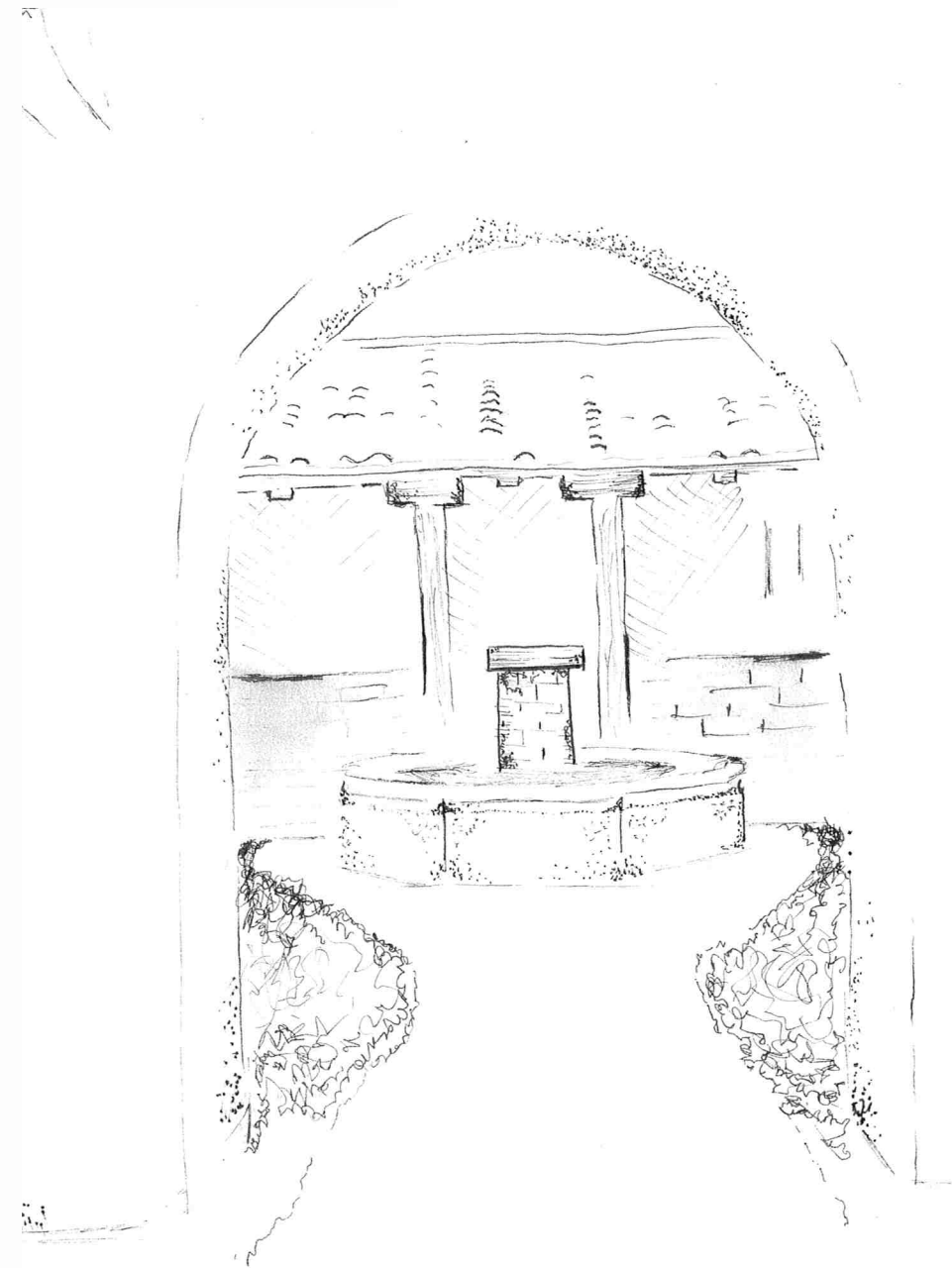

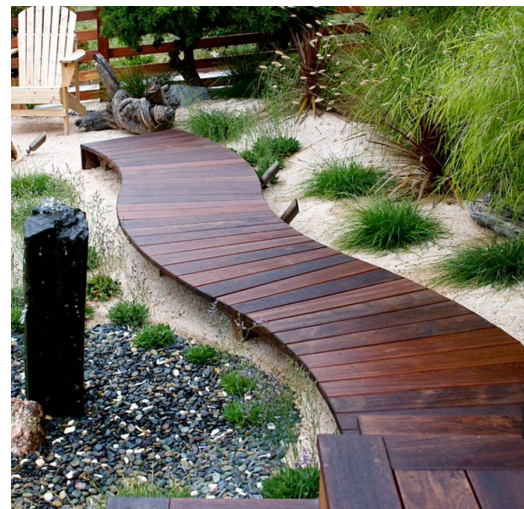

PRECEDENT IMAGERY



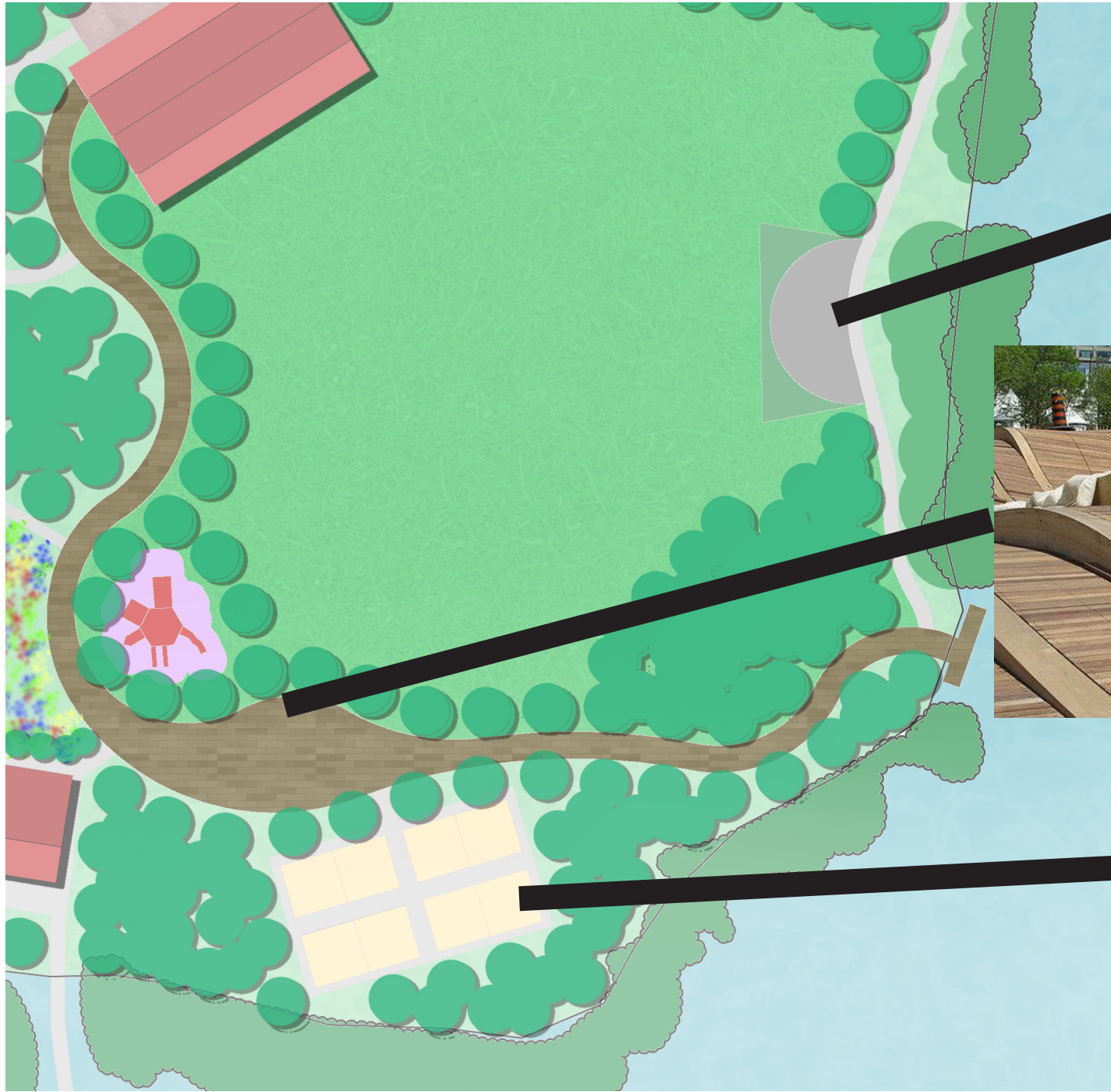

PRECEDENT IMAGERY

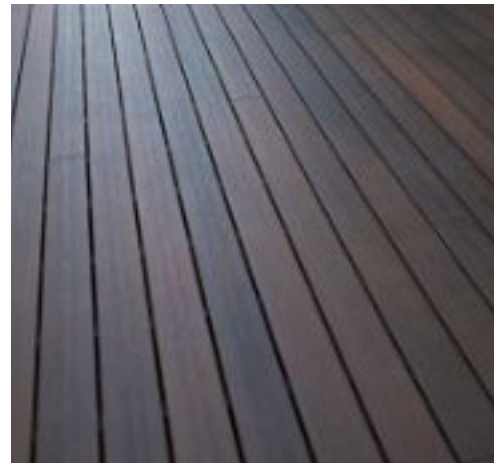
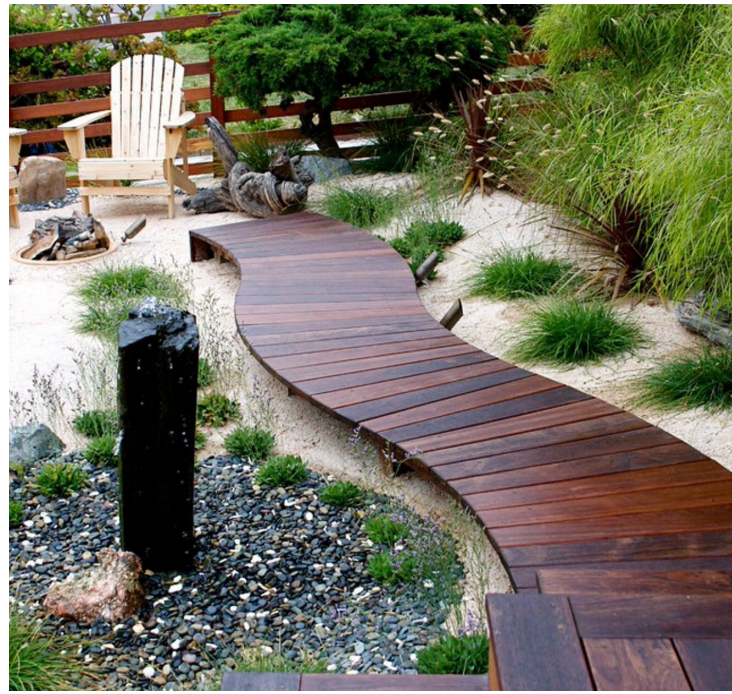

Boardwalk Materials

Tile

Pavers





CARPENTARIA PALM

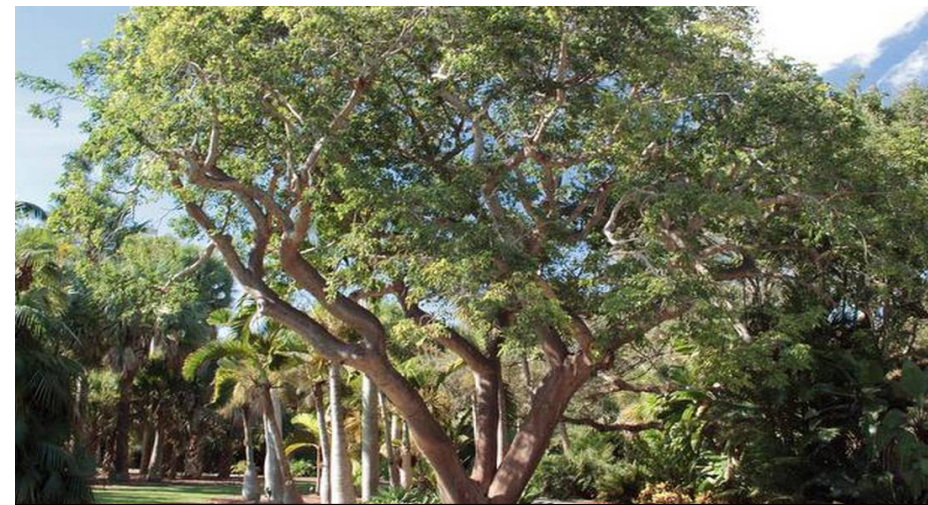

GUMBO LIMBO TREE



SOUTHERN SHIELD FERN



MUHLY GRASS



WILD TAMARIND



FLORIDA BUCKEYE



SAW PALMETTO



COONTIE FERN



FIREBUSH



BAHAMA CASSIA



FLORIDA PINE



ARENKA PALM

