



**BELGARD**® | PAVES THE WAY™

**FORMS+SURFACES**®



**UNIVERSITY OF GEORGIA**  
College of  
Environment + Design

# GULF COVE PARK

Kimley»Horn



ANDREW PETERSON

BENNETT STONE

DILLON WHITE

HADDEN POWELL

MEGAN JANSSEN

## TABLE OF CONTENTS

|                           |       |
|---------------------------|-------|
| VISION STATEMENT & GOALS  | 3     |
| SITE ANALYSIS & INVENTORY | 4     |
| DESIGN ALTERNATIVES       | 5     |
| CASE STUDIES              | 6     |
| PRECEDENT IMAGES          | 7-8   |
| MASTER PLAN               | 9     |
| VIGNETTES                 | 10-15 |
| MATERIALS                 | 16-17 |
| PLANT PALETTE             | 18-19 |
| ACKNOWLEDGEMENTS          | 20    |

# GULF COVE PARK: KIMLEY-HORN CHARRETTE

## VISION STATEMENT & GOALS

### VISION STATEMENT

FOR THIS PROJECT WE WERE GIVEN ENOUGH INFORMATION TO GENERATE A DESIGN THAT COULD COMMONLY BE FOUND IN FLORIDA, BUT NOT ENOUGH TO HINDER OUR CREATIVITY. EMBRACING ONE OF THE CHARACTERISTICS THAT PRESENTS A CHALLENGE IN THIS DESIGN, WE DECIDED TO DRAW INSPIRATION FROM THE MANGROVES THAT FRAME THE OUTSIDE EDGES, DRAWING INSPIRATION FROM BOTH THEIR FORM AND ECOLOGICAL VALUE. RECOGNIZING THAT A LANDSCAPE'S SUSTAINABILITY IS ALSO CLOSELY TIED TO HUMAN USERS, WE SOUGHT TO INJECT EDUCATION OPPORTUNITIES AND NOVEL RECREATION ACTIVITIES TO NOT ONLY MAKE USERS MORE FAMILIAR WITH THEIR LOCAL LANDSCAPE, BUT GROW CLOSER TO IT.

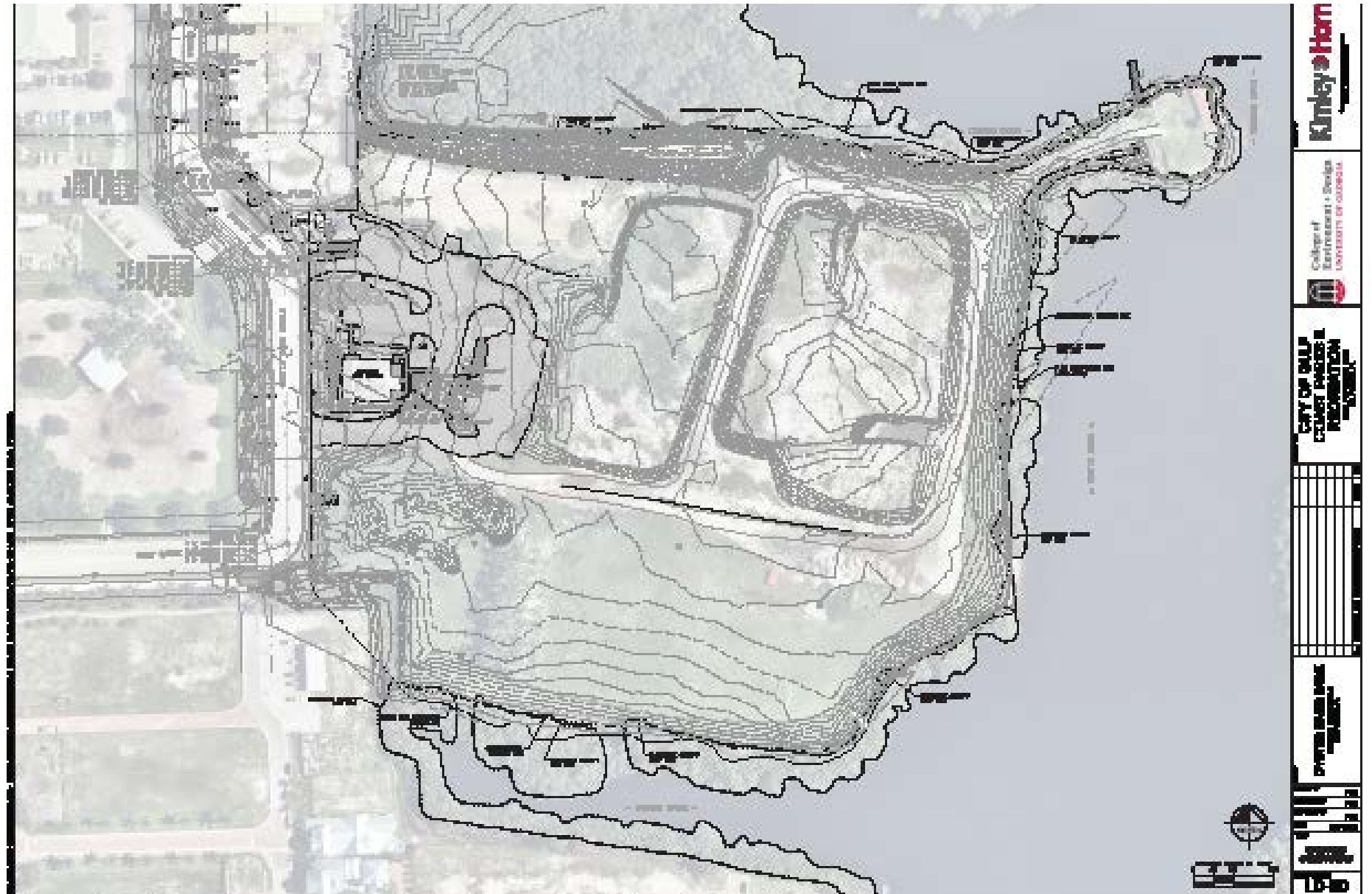

### PROJECT GOALS

- INCREASE THE "BREATHING ROOM" FOR LOCAL MANGROVES TO ALLOW FOR NATURAL REFORESTATION
- CREATE EDUCATIONAL OPPORTUNITIES IN THE LANDSCAPE SUCH AS ON THE BOARDWALK, COMMUNITY CENTER, OR LOOKOUT TOWER
  - INCREASE ECOLOGICAL PERFORMANCE
- CREATE A COMMUNITY HUB THAT ALLOWS USERS TO INTERACT WITH THE LOCAL LANDSCAPE AND CREATE EMOTIONAL ATTACHMENT
  - REFLECT NATURAL CHARACTERISTICS IN BUILT INTERVENTIONS

# GULF COVE PARK: KIMLEY-HORN CHARRETTE

## SITE ANALYSIS & INVENTORY

### SITE ANALYSIS/INVENTORY

UNDERSTANDING THE EXISTING CONDITIONS OF THE SITE IS CRUCIAL IN MAKING INFORMED DESIGN DECISIONS THAT REFLECT THE SITE'S OPPORTUNITIES AND CONSTRAINTS. GIVEN THE NATURE OF THE DESIGN CHALLENGE WE WERE GIVEN MORE FREEDOM THAN LIMITATIONS AS IT RELATES SURROUNDING SITE CONDITIONS, LOCATION, AND STAKEHOLDERS.

CONSEQUENTLY, WITHOUT OUTSIDE LIMITATIONS WE LOOKED INWARDS AND INVESTIGATED THE SITE'S CHARACTERISTICS SUCH AS ELEVATION, SOIL CONDITIONS, SUN LOCATION, EXISTING VEHICULAR INFRASTRUCTURE AND MOST IMPORTANTLY THE MANGROVE TREES.

THE PERIPHERY MANGROVE FORESTS WERE EXPRESSED AS BEING UNTOUCHABLE GIVEN THEIR PROTECTED NATURE. FURTHERMORE, THEY PRESENT A UNIQUE ECOSYSTEM THAT IS VITAL FOR THE ECOLOGICAL HEALTH OF THE COASTLINE. TO GET RID OF THESE RARE ECOSYSTEMS WOULD NOT ONLY SERVE TO UNDERMINE THE SUSTAINABILITY OF THE SITE, BUT ALSO DEPRIVE USERS OF THEIR UNIQUE CHARACTER.

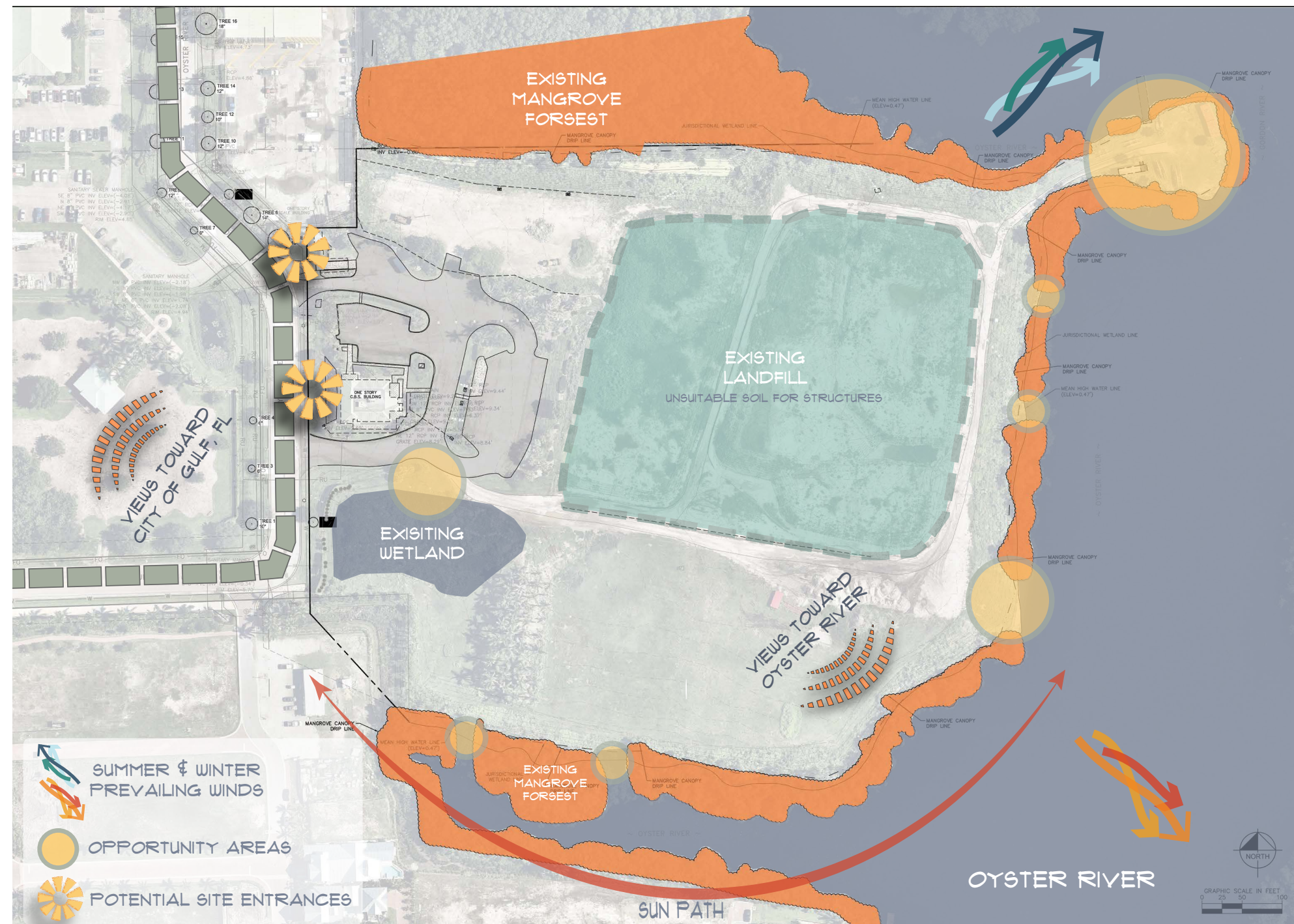

# GULF COVE PARK: KIMLEY-HORN CHARRETTE

## DESIGN ALTERNATIVES

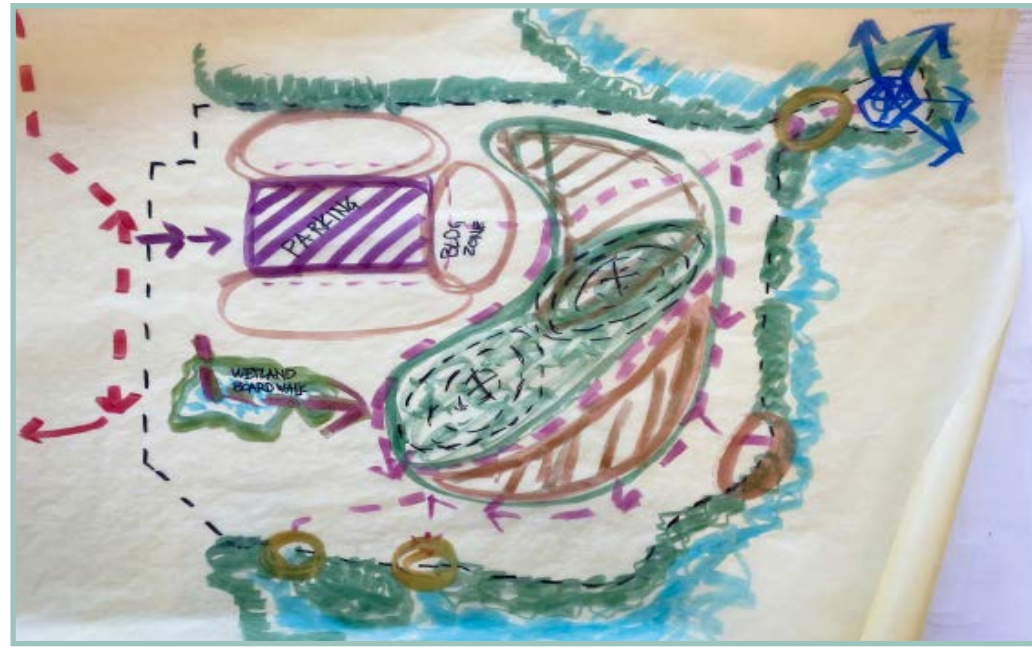
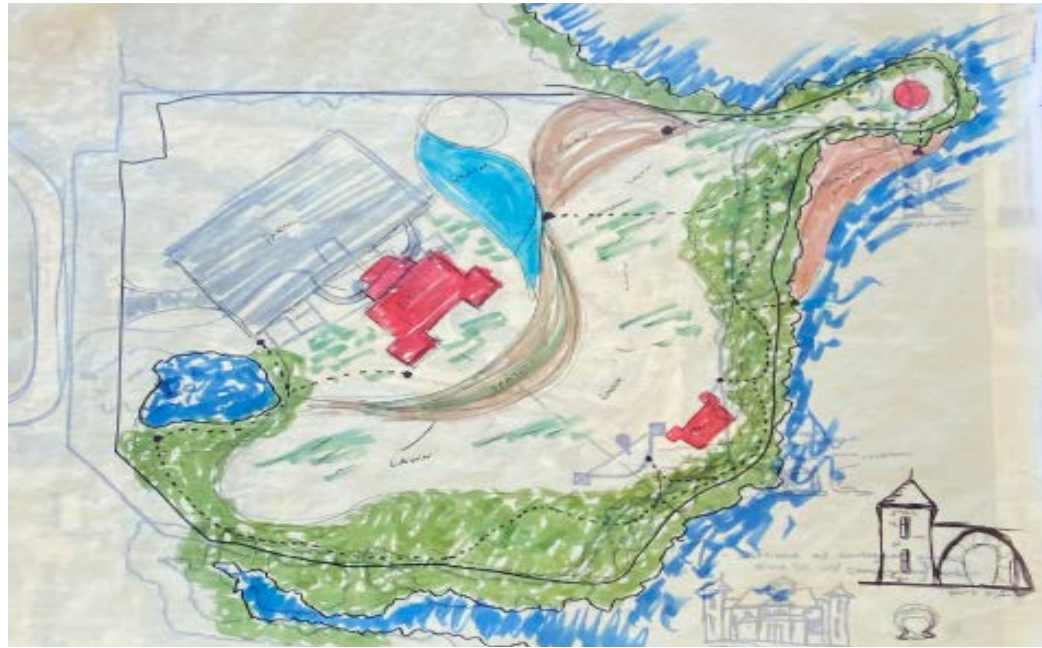

## DESIGN ALTERNATIVES

FOR THIS DESIGN CHARRETTE OUR DESIGN TEAM WAS GIVEN MINIMAL INFORMATION TO ENCOURAGE UNIQUE IDEA GENERATION AND TO ALLOW US TO REALLY PUSH THE ENVELOPE ON WHAT WE COULD IMAGINE. TAKING THIS IDEA IN STRIDE, AFTER OUR INITIAL BRIEFING OF THE SITE OUR TEAM REFLECTED ON WHAT WE THOUGHT WAS IMPORTANT FROM OUR BRIEFING WITH FIRM MEMBERS, AND PROCEEDED TO SEPARATELY GENERATE FUNCTIONAL DIAGRAMS.

FROM THESE WE CAME UP WITH KEY FEATURES THAT WE WANTED TO INCLUDE SUCH AS:

- EDUCATIONAL SIGNAGE
- BIORETENTION / STORMWATER ED.
- SHORELINE RESTORATION
- RESILIENCE / FLOOD MITIGATION
- EQUITABLE ACCESS

# GULF COVE PARK: KIMLEY-HORN CHARRETTE

## CASE STUDIES

### RIVER WALK PARK PORT ORANGE, FLORIDA



RIVERWALK PARK IS SPLIT INTO TWO SECTIONS BORDERING THE RIVERSIDE PAVILION ON THE HALIFAX RIVER. THE NORTH SECTION OF THE PARK INCLUDES A KAYAK/CANOE/PADDLE BOARD LAUNCH, A NEW BOARDWALK, FISHING PIERS, A 12' WIDE TRAIL, CONCESSION STAND, AND RESTROOM FACILITY. SANDY POINT PROGRESSIVE SPORTS CURRENTLY OPERATES OUT OF THE CONCESSION STAND AND RENTS PADDLE EQUIPMENT TO THE PUBLIC.

THE SOUTH SECTION OF THE PARK INCLUDES A SPLASH PAD, PLAYGROUND, EVENT LAWN, CONCESSION STAND, RESTROOM FACILITY, A RIVERFRONT PROMENADE AREA, EVENT STAGE, PICNIC PAVILIONS, AND A 12' TRAIL WAY ENCOMPASSING THE PARK.

### RENAISSANCE PARK, CHATTANOOGA, TEN-



RENAISSANCE PARK IS A 22-ACRE URBAN BROWNFIELD REDEVELOPMENT PROJECT WITHIN CHATTANOOGA'S NATIONALLY-RECOGNIZED TENNESSEE RIVER PARK. COMPLETED IN 2006, THIS RIVERFRONT PROJECT TRANSFORMED A BLIGHTED POST-INDUSTRIAL SITE KNOWN TO BE LEACHING CONTAMINANTS INTO SURFACE AND GROUNDWATER RESOURCES INTO A CELEBRATED PUBLIC PARK THAT HAS BEEN A CATALYST FOR REINVESTMENT IN CHATTANOOGA'S GROWING NORTHSIDE NEIGHBORHOOD.

RENAISSANCE PARK PROVIDES A CANVAS FOR SOCIAL ENGAGEMENT, HEALTHY LIFESTYLES, AND ENACTS SERVICES OF PRESERVED FLOODPLAIN FOREST, MEADOW PLANTINGS AND A CONSTRUCTED WETLAND THAT TREATS SITE STORMWATER AND INCREASES FLOODPLAIN STORAGE CAPACITY. PRESERVATION AREAS AND NATIVE MEADOWS REDUCE CONSTRUCTION AND MAINTENANCE COSTS, WHILE ICONIC LANDFORMS SAFELY AND ARTISTICALLY ENCLOSE CONTAMINATED SOILS. THE PARK HOSTS PUBLIC EVENTS, EXHIBITIONS OF PUBLIC ART, AND COMMEMORATES THE SITE'S ROLE IN SIGNIFICANT HISTORIC EVENTS, INCLUDING THE TRAIL OF TEARS, ENCAMPMENT OF LIBERATED SLAVES, AND THE LOCATION OF THE CITY'S FIRST BRIDGE TO CROSS THE TENNESSEE RIVER.

### COACHMAN PARK CLEARWATER, FLORIDA



DESIGNED TO CONNECT THE WATERFRONT AND THE DOWNTOWN COMMUNITY, IMAGINE CLEARWATER INCLUDES AN EXPANSIVE PARK AND RECREATIONAL SPACES, A GATEWAY PLAZA AND BLUFF WALK THAT CONNECTS THE PARK TO DOWNTOWN, A BAY WALK PROMENADE OVERLOOKING THE INTRACOASTAL WATERWAY, AND A LAKE AREA WITH PICNIC SHELTERS.

THE REDUCED PARKING AREA AND ADDITION OF RIDE SHARE DROP-OFF AREAS AIM TO REDUCE VEHICULAR TRAFFIC AND PROMOTE WALKABILITY AND THE USE OF PUBLIC TRANSPORTATION. TO BRING THE LOCAL ART COMMUNITY INSIDE THE ENVELOPE, STANTEC WILL INCORPORATE SPACES THROUGHOUT TO PROVIDE THE A BLANK CANVAS FOR FEATURING ART INSTALLATIONS THAT SHOWCASE THE COMMUNITY AND ITS CULTURE.

THE ADDITIONS TO COACHMAN PARK ALSO INCLUDE AN OUTDOOR PERFORMANCE BANDSHELL AND STAGE WITH COVERED SEATING FOR 4,000.

# GULF COVE PARK: KIMLEY-HORN CHARRETTE

## PRECEDENT IMAGES

### INSPIRATION

WETLANDS, EARTHWORKS, BOARDWALKS, PLAYGROUND AND SPLASH PADS



# GULF COVE PARK: KIMLEY-HORN CHARRETTE

## PRECEDENT IMAGES

### INSPIRATION

AMPITHEATER SEATING + PAVILLION

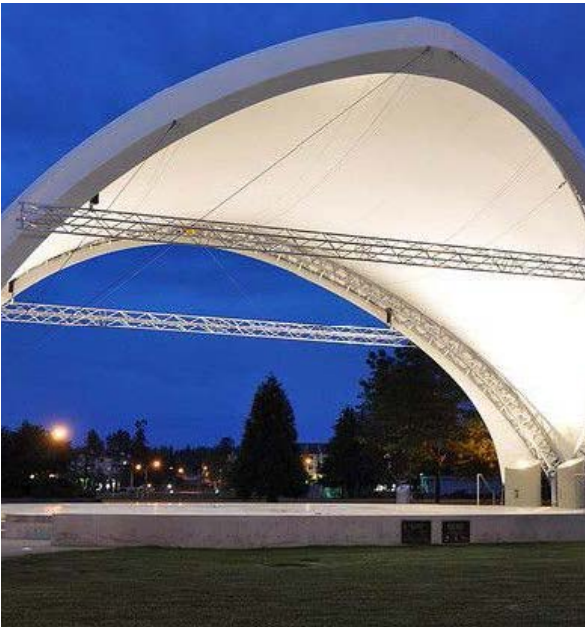
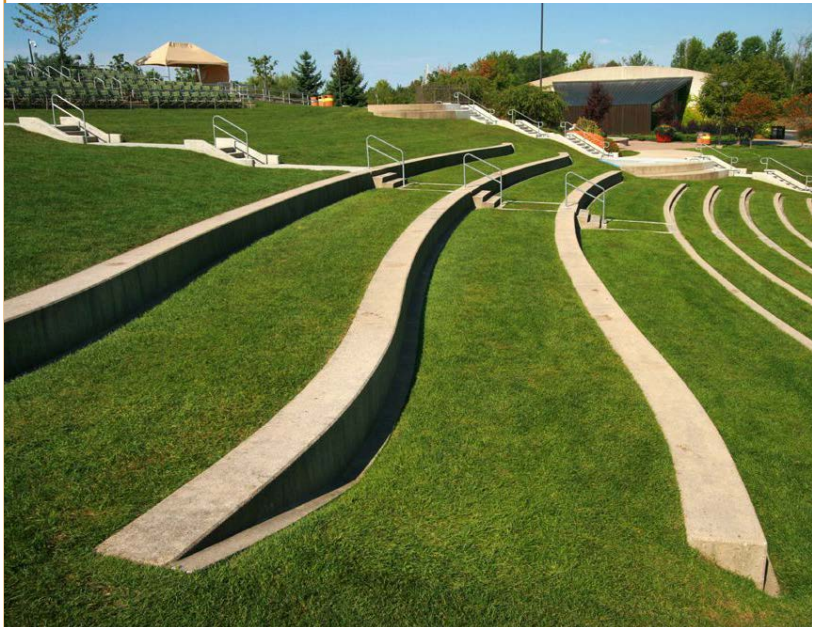

COMMUNITY CENTER + OBSERVATION TOWER





# GULF COVE PARK: KIMLEY-HORN CHARRETTE

RENDERED MASTERPLAN

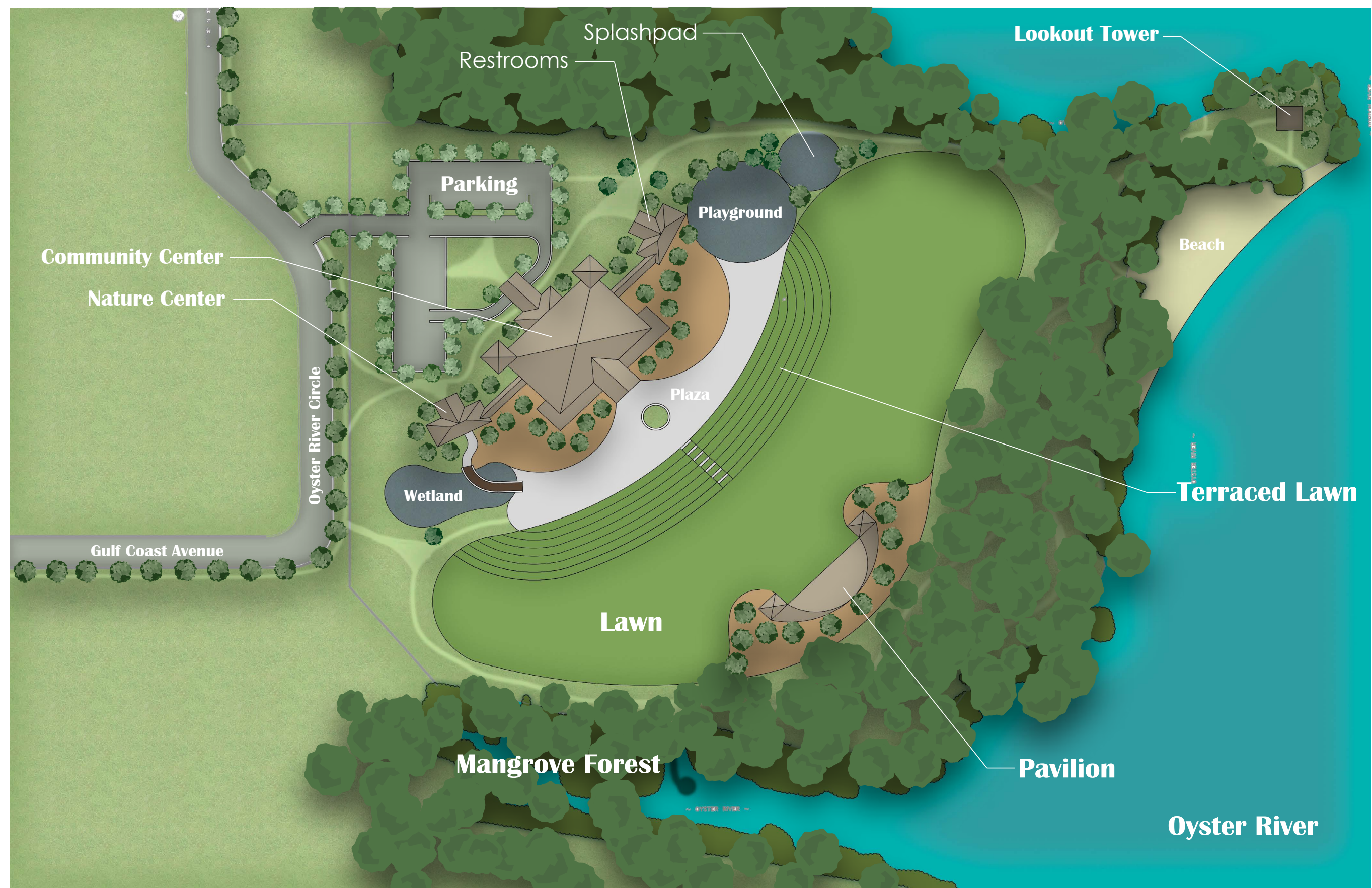

## GULF COVE PARK: KIMLEY-HORN CHARRETTE



ABOVE IS A VIEW FROM THE PARKING LOT OF THE COMMUNITY CENTER. THE STYLE OF THE ARCHITECTURE THROUGHOUT THE PARK IS COASTAL CRAFTSMAN. NATIVE PLANTINGS TO SOUTHWEST FLORIDA ADORN THE SITE.

## GULF COVE PARK: KIMLEY-HORN CHARRETTE



ABOVE IS A VIEW OF THE LOOKOUT TOWER FROM THE BEACH AREA. THE BEACH IS A GREAT PLACE FOR RECREATIONAL ACTIVITIES SUCH AS KAYAKING, AS WELL AS VIEWING THE NATIVE MANGROVE TREES.

# GULF COVE PARK: KIMLEY-HORN CHARRETTE



ABOVE IS THE VIEW WALKING DOWN THE PATH WHEN APPROACHING THE LOOKOUT TOWER.

# GULF COVE PARK: KIMLEY-HORN CHARRETTE



ABOVE IS A NIGHTTIME VIEW OF THE TERRACED LAWN. THIS AREA SERVES AS SEATING FOR EVENTS CENTERED AROUND THE PAVILION.

## GULF COVE PARK: KIMLEY-HORN CHARRETTE



ABOVE IS A VIEW OF THE SPLASH PAD PROPOSED ON SITE. THE WATER FEATURES ARE MODELED AFTER THE MANGROVE TREES NATIVE TO THE GEOGRAPHIC AREA.

## GULF COVE PARK: KIMLEY-HORN CHARRETTE



ABOVE IS A VIEW OF THE EDUCATION WETLAND. THE BOARDWALK CONNECTS THE PARK TO THE NATURE CENTER AND OFFERS A LOOKOUT OVER THE WETLAND, WHILE INCLUDING ADA ACCESSIBILITY.

# GULF COVE PARK: KIMLEY-HORN CHARRETTE

## MATERIALS

### SITE FURNISHINGS + HARDSCAPES

#### DETAILS



BELGARD BELGIAN COBBLE



PRE-CAST CONCRETE  
BOARDWALK



F+S UNIVERSAL PLANTER

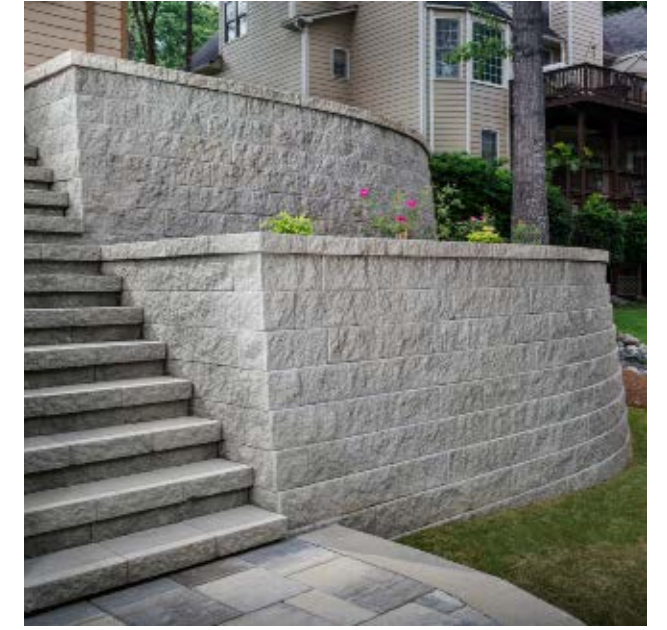

BELGARD DIAMOND PRO  
RETAINING WALL AND STAIR  
SYSTEM (GRAY)



F+S CORDIA LITTER AND  
RECYCLING RECEPTACLE



F+S CAPITOL BIKE RACK



RUBBER AQUATIC SURFACING  
(SPLASH PAD)



F+S MITER PLANTER



# GULF COVE PARK: KIMLEY-HORN CHARRETTE

## MATERIALS

### SITE FURNISHINGS: SEATING



BOARDWALK BENCH (RECLAIMED TEAK HARDWOOD, COOL GREY POWDERCOAT)



CAFE AVIVO PEDESTAL TABLE (VENTO PERFORATION PATTERN)



APEX TABLE ENSEMBLE (RECLAIMED TEAK HARDWOOD)

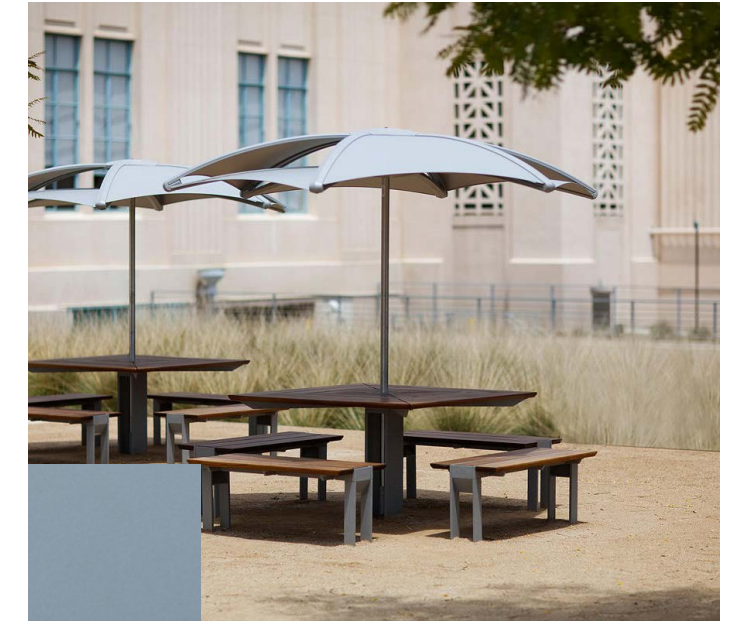

SOLERIS SUNSHADE (SOLID, COOL GREY TEXTURE)

### SITE FURNISHINGS: LIGHTING



TRIADA BALLARD



CORDIA PEDESTRIAN LIGHTING

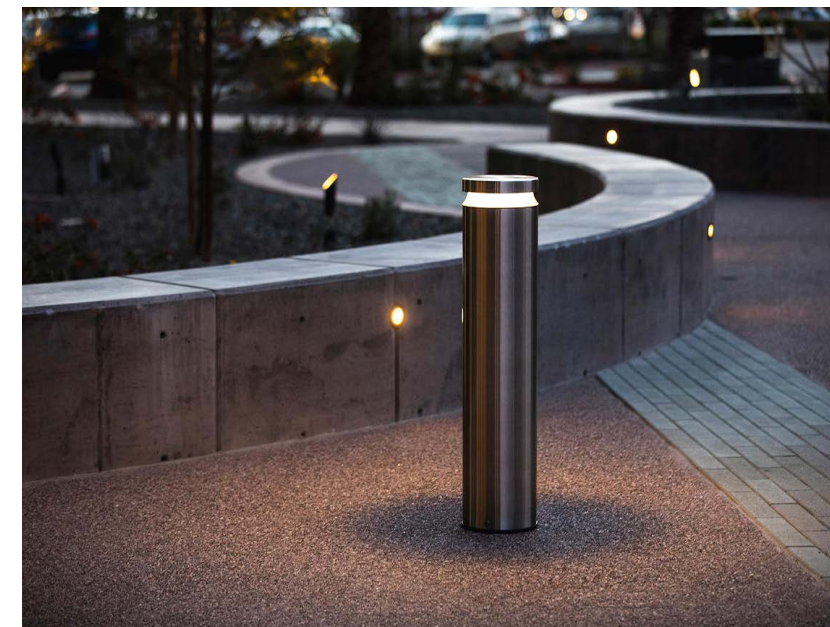

HELIO M30/K4 SECURITY BOLLARD

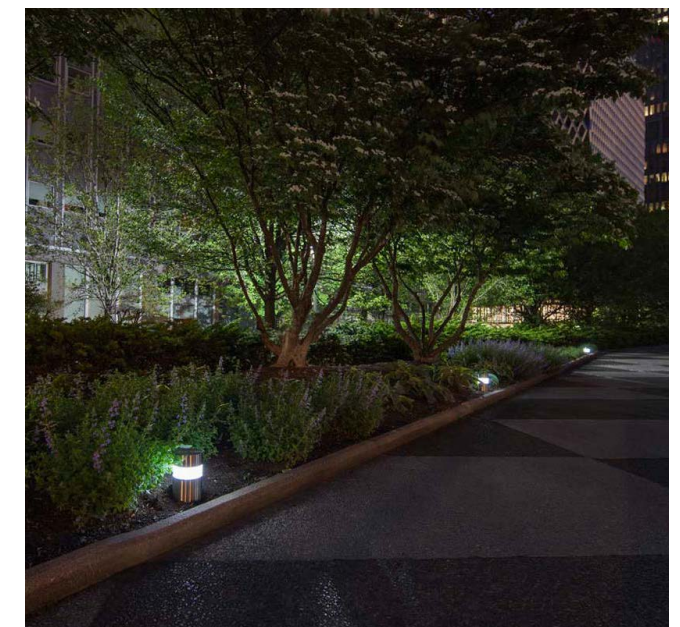

LIGHT COLUMN PATHWAY BOLLARD

# GULF COVE PARK: KIMLEY-HORN CHARRETTE

## PLANT PALETTE

### NATIVE TREES



GUMBO LIMBO  
*Bursera simaruba*



BALD CYPRESS "AUTUMN GOLD"  
*Taxodium Distichum*



LIVE OAK  
*Quercus Virginiana*



SABAL PALM  
*Sabal palmetto*

### NATIVE SHRUBS



WINGED SUMAC  
*Rhus copallinum*



WAX MYRTLE  
*Morella cerifera*



COONTIE  
*Zamia pumila*



SAW PALMETTO  
*Serenoa repens*

# GULF COVE PARK: KIMLEY-HORN CHARRETTE

## PLANT PALETTE

### NATIVE SHRUBS



WALTER'S VIBURNUM  
*Viburnum obovatum*



SEA GRAPE  
*Coccoloba uvifera*



BEACH ROSEMARY  
*Conradina canescens*



BUTTONWOOD  
*Conradina canescens*

### ORNAMENTALS



MUHLY GRASS  
*Muhlenbergia capillaris*



BIRDS OF PARADISE  
*Strelitzia reginae*



CAROLINA SEA LAVENDER  
*Limonium carolinianum*



ANISE HYSOP  
*Agastache foeniculum*

# GULF COVE PARK: KIMLEY-HORN CHARRETTE

## ACKNOWLEDGEMENTS AND CONCLUSIONS

Thank you for taking the time to look over our final design for the Oyster River Site and for providing this opportunity to stretch our creative legs. It was not long ago that all of us were forced to design and collaborate from home and for many of us this was our first design charrette and we are thankful that it was with Kimley-Horn and the other professionals that were gracious to take part. We hope it's not too long before we have the chance to design together again. Thank you!